

APPENDIX A
THERMAL UTILITY DISTRIBUTION SYSTEM



SITE LOCATION
 PRAIRIE VIEW A&M UNIVERSITY
 100 ENERGY WAY SUITE 1000
 FORT WORTH, TEXAS 76102
 PRAIRIE VIEW, TX 77446



BURNS & MCDONNELL
 100 ENERGY WAY SUITE 1000
 FORT WORTH, TEXAS 76102
 817.437.4361

PRAIRIE VIEW A&M UNIVERSITY



DATE	05/24/2017	PKY	PKY
DESIGNED	PKY	CHECKED	ATF
2017 UTILITY MASTER PLAN MAIN CAMPUS BUILDINGS-GROWTH BASE CASE PHASE 1 FUTURE BUILDOUT Project: 98470 Drawing: SK1 - 0			

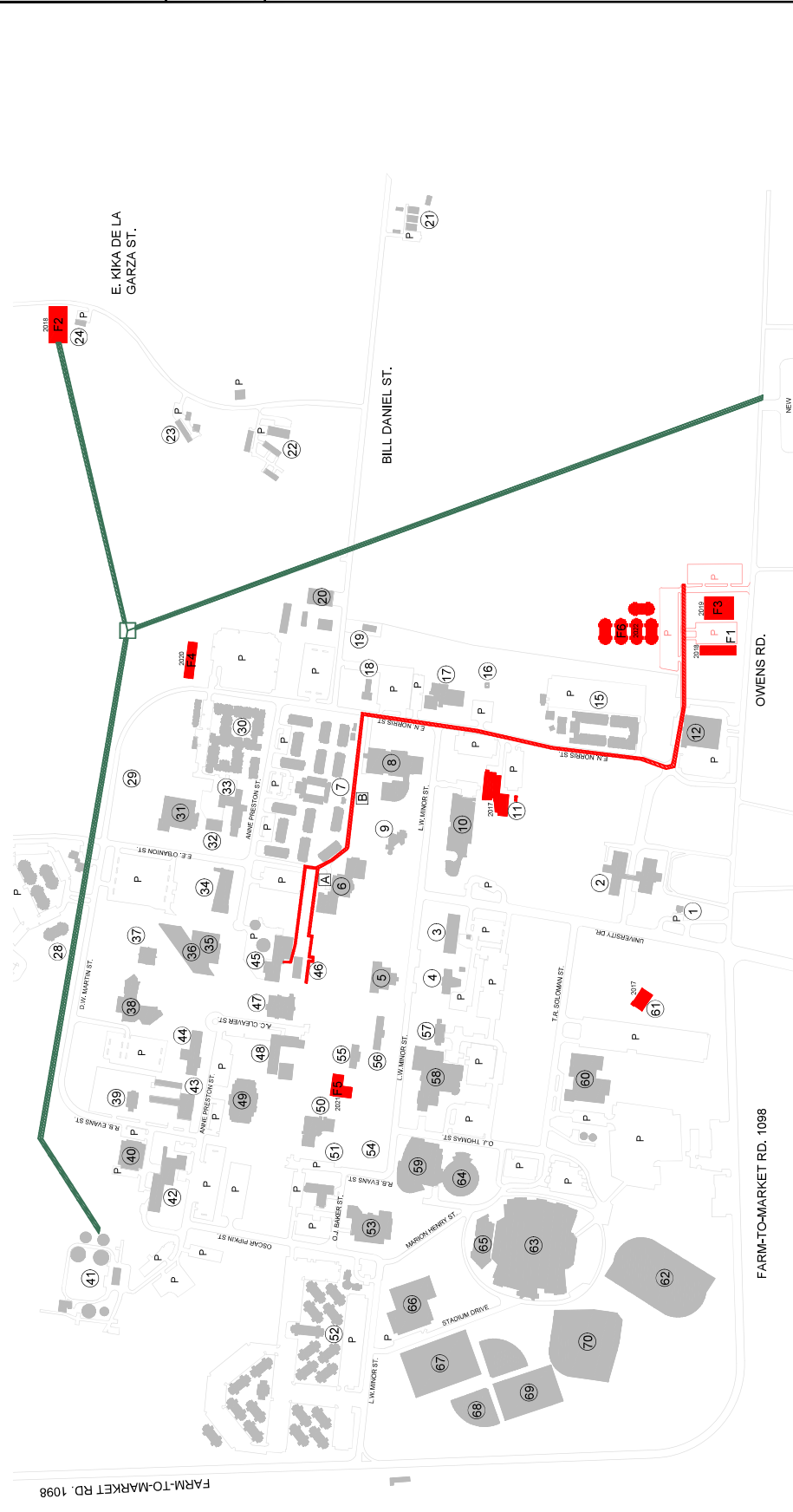

- LEGEND:**
- 1. Thomas E. Gray Center (Visitor Information Center)
 - 2. H.T. Jones Elementary School
 - 3. M.T. Harrington Science Building
 - 4. W.P. Thomas Building/Administration Building
 - 5. Student Center
 - 6. John B. Coleman Library
 - 7. University College
 - 8. Elmer E. O'Bannon Science Building
 - 9. Johnson-Philip All Faiths Chapel
 - 10. Natheiyne A. Kennedy Architecture Building School of Architecture
 - 11. Architecture Fabrication Design Center
 - 12. Panther Plaza
 - 13. University View (Phase VII)
 - 14. Solar Observatory
 - 15. Carden-Waller Cooperative Veterinary Hospital
 - 16. A. N. Poindbexter Veterinary Hospital
 - 17. A. N. Poindbexter Veterinary Hospital
 - 18. A. N. Poindbexter Veterinary Hospital
 - 19. A. N. Poindbexter Veterinary Hospital
 - 20. A. N. Poindbexter Veterinary Hospital
 - 21. A. N. Poindbexter Veterinary Hospital
 - 22. A. N. Poindbexter Veterinary Hospital
 - 23. A. N. Poindbexter Veterinary Hospital
 - 24. A. N. Poindbexter Veterinary Hospital
 - 25. A. N. Poindbexter Veterinary Hospital
 - 26. Slave Cemetery (Not Shown)
 - 27. Prairie View Memorial Cemetery (Not Shown)
 - 28. University Village North (Phase III)
 - 29. Student Park
 - 30. University Village (Phase VIII)
 - 31. Jesse & Mary Jones Cooperative Agricultural Research Building
 - 32. Farm Shop
 - 33. E.B. Evans Animal Industries Building
 - 34. Electrical Engineering Building
 - 35. Chemical Engineering Building
 - 36. C.L. Wilson Engineering Building
 - 37. S.G. Collins Engineering Technology Building
 - 38. Transportation Center
 - 39. Henrietta Farrell Hall
 - 40. Waste Water Plant
 - 41. Central Receiving Building/University Police Department
 - 42. Physical Plant Administration Building
 - 43. Physical Plant Administration Building
 - 44. Physical Plant Administration Building
 - 45. G.R. Woodfolk Social & Political Science Building
 - 46. Hilliard Hall Communication Building
 - 47. Agriculture and Business Multipurpose Building
 - 48. College of Agriculture and Human Sciences
 - 49. College of Agriculture and Human Sciences
 - 50. College of Agriculture and Human Sciences
 - 51. College of Agriculture and Human Sciences
 - 52. College of Agriculture and Human Sciences
 - 53. College of Agriculture and Human Sciences
 - 54. College of Agriculture and Human Sciences
 - 55. College of Agriculture and Human Sciences
 - 56. College of Agriculture and Human Sciences
 - 57. College of Agriculture and Human Sciences
 - 58. College of Agriculture and Human Sciences
 - 59. College of Agriculture and Human Sciences
 - 60. College of Agriculture and Human Sciences
 - 61. College of Agriculture and Human Sciences
 - 62. Track and Field Complex
 - 63. Panther Stadium (Blackshear Football Field)
 - 64. New Panther Stadium (Baby Dome)
 - 65. Athletic Field House
 - 66. Tennis Courts
 - 67. Soccer Field
 - 68. Lady Panthers Softball Field
 - 69. Practice Field
 - 70. John W. Tankersley Baseball Field
- PHASE 1 UTILITY CORRIDOR** 10' STM / 4' CR 24\"/>
- PHASE 1, 2018&2022 (4.5YR):**
- F1 - POLICE STATION (10,000 gsf)
 - F2 - MEAT PROCESSING FACILITY (20,000 gsf)
 - F3 - ICCE BUILDING (10,000 gsf)
 - F4 - ROTC BUILDING (10,000 gsf)
 - F5 - CULTURAL ARTS CENTER (21,000 gsf)
 - F6 - HOUSING 2 (from 2011 MP) (110,000 gsf)

SITE LOCATION
 PRAIRIE VIEW A&M UNIVERSITY
 100 ENERGY WAY SUITE 1000
 FORT WORTH, TX 76102
 PRAIRIE VIEW, TX 77446

BURNS & MCDONNELL
 100 ENERGY WAY SUITE 1000
 FORT WORTH, TX 76102
 817.437.4361

PRAIRIE VIEW A&M UNIVERSITY

DATE	05/24/2017	PKY	PKY
DESIGNED		PKY	PKY
CHECKED		ATF	ATF
2017 UTILITY MASTER PLAN			
MAIN CAMPUS BUILDINGS-GROWTH			
BASE CASE PHASE 3 FUTURE BUILDOUT			
PROJECT	98470	REV.	
DRAWING		REV.	
		SK3	0

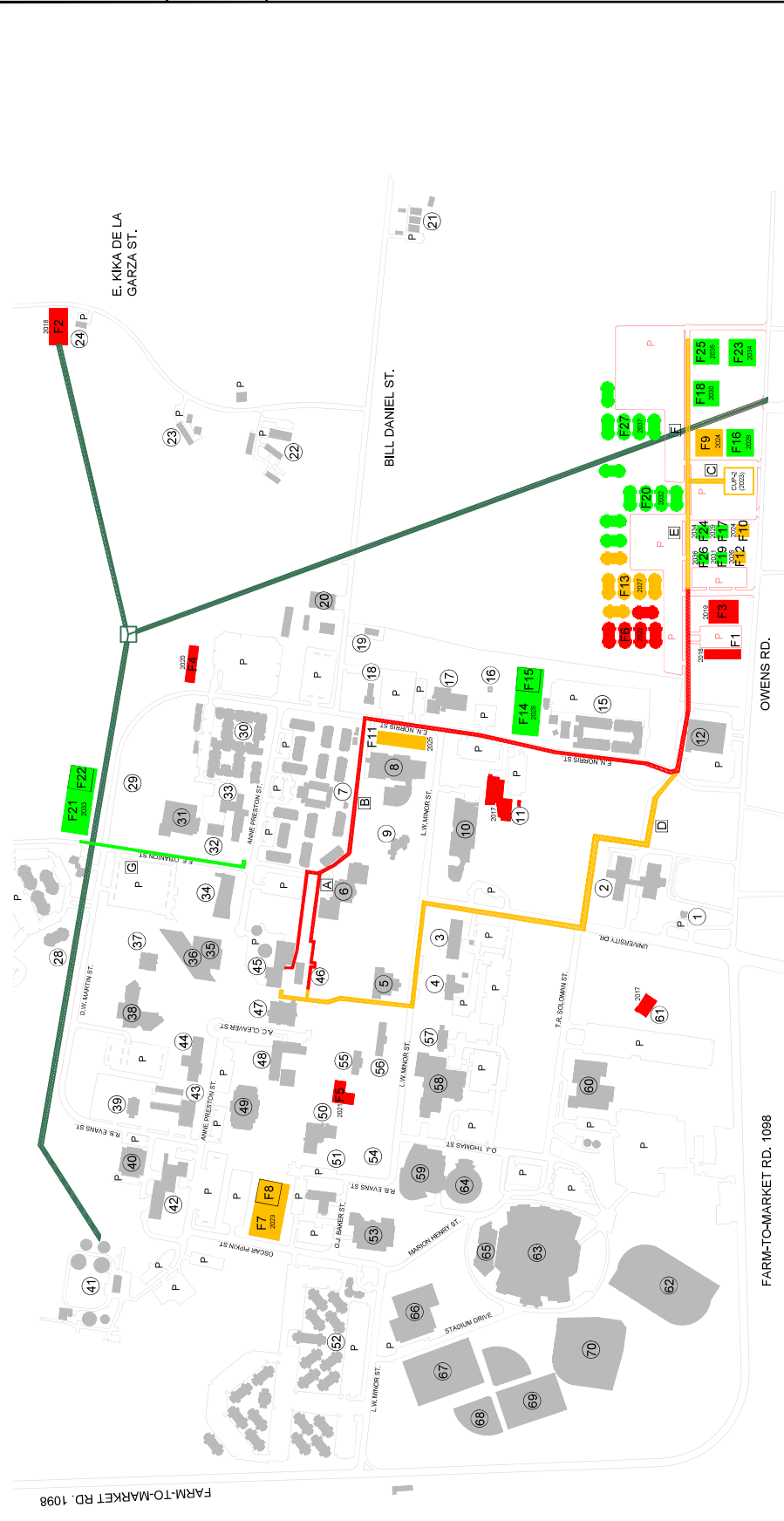

- LEGEND:**
- 1. Thomas E. Gray Center (Visitor Information Center)
 - 2. H.T. Jones Elementary School
 - 3. M.T. Harrington Science Building
 - 4. W.P. Thomas Building/Administration Building
 - 5. Student Plaza
 - 6. John B. Coleman Library
 - 7. University College
 - 8. Elmer E. O'Bannon Science Building
 - 9. Johnson-Philo All Faiths Chapel
 - 10. Nathefayne A. Kennedy Architecture Building School of Architecture
 - 11. Architecture Fabrication Design Center
 - 12. Pattern Plaza
 - 13. University View (Phase VII)
 - 14. Carden-Walker Cooperative Veterinary Hospital
 - 15. A. N. Ponder Veterinary Hospital
 - 16. A. N. Ponder Veterinary Hospital
 - 17. A. N. Ponder Veterinary Hospital
 - 18. A. N. Ponder Veterinary Hospital
 - 19. A. N. Ponder Veterinary Hospital
 - 20. A. N. Ponder Veterinary Hospital
 - 21. A. N. Ponder Veterinary Hospital
 - 22. A. N. Ponder Veterinary Hospital
 - 23. A. N. Ponder Veterinary Hospital
 - 24. A. N. Ponder Veterinary Hospital
 - 25. A. N. Ponder Veterinary Hospital
 - 26. Slave Cemetery (Not Shown)
 - 27. Prairie View Memorial Cemetery (Not Shown)
 - 28. University Village North (Phase III)
 - 29. Student Park
 - 30. University Village South (Phase III)
 - 31. University Village South (Phase III)
 - 32. Farm Shop
 - 33. E.B. Evans Animal Industries Building
 - 34. Electrical Engineering Building
 - 35. Chemical Engineering Building
 - 36. C.L. Wilson Engineering Building
 - 37. S.P. Collins Engineering Technology Building
 - 38. S.P. Collins Engineering Technology Building
 - 39. Transportation Center
 - 40. Henrietta Farrell Hall
 - 41. Waste Water Plant
 - 42. Central Receiving Building/University Police Department
 - 43. Physical Plant Administration Building
 - 44. Physical Plant Administration Building
 - 45. Physical Plant Administration Building
 - 46. Physical Plant Administration Building
 - 47. Hilliard Hall Communication Building
 - 48. Hilliard Hall Communication Building
 - 49. Hilliard Hall Communication Building
 - 50. Hilliard Hall Communication Building
 - 51. Hilliard Hall Communication Building
 - 52. Hilliard Hall Communication Building
 - 53. Hilliard Hall Communication Building
 - 54. Hilliard Hall Communication Building
 - 55. Hilliard Hall Communication Building
 - 56. Hilliard Hall Communication Building
 - 57. Hilliard Hall Communication Building
 - 58. Hilliard Hall Communication Building
 - 59. Hilliard Hall Communication Building
 - 60. Hilliard Hall Communication Building
 - 61. Hilliard Hall Communication Building
 - 62. Track and Field Complex
 - 63. Panther Stadium (Blackshear Football Field)
 - 64. Panther Stadium (Blackshear Football Field)
 - 65. Panther Stadium (Blackshear Football Field)
 - 66. Athletic Field House
 - 67. Soccer Field
 - 68. Lady Panthers Softball Field
 - 69. Practice Field
 - 70. John W. Tankersley Baseball Field
- PHASE 1 UTILITY CORRIDOR:** 10" STM / 4" CR / 24" CHW SANITARY SEWER ONLY.
- PHASE 2 UTILITY CORRIDOR:** 10" STM / 4" CR / 24" CHW
- PHASE 3 UTILITY CORRIDOR:** 10" STM / 4" CR / 24" CHW
- PHASE 1:** 2018-2022 (5-YR):
 F1 - POLICE STATION (10,000 gsf)
 F2 - MEAT PROCESSING FACILITY (20,000 gsf)
 F3 - ROTC BUILDING (10,000 gsf)
 F4 - ROTC BUILDING (10,000 gsf)
 F5 - CULTURAL ARTS CENTER (21,000 gsf)
 F6 - HOUSING 2 (from 2011 MP) (110,000 gsf)
- PHASE 2:** 2023-2027 (6-YR):
 F7 - FUTURE ACADEMIC BUILDING (105,080 gsf)
 F8 - FUTURE STUD. ACTIVITIES BUILDING (18,860 gsf)
 F9 - FUTURE STUD. ACTIVITIES BUILDING (18,860 gsf)
 F10 - FUTURE STUD. ACTIVITIES BUILDING (18,860 gsf)
 F11 - FUTURE STUD. ACTIVITIES BUILDING (18,860 gsf)
 F12 - FUTURE STUD. ACTIVITIES BUILDING (18,860 gsf)
 F13 - FUTURE STUD. ACTIVITIES BUILDING (18,860 gsf)
- PHASE 3:** 2028-2037 (11-20 YRS):
 F14 - FUTURE ACADEMIC BUILDING (105,080 gsf)
 F15 - FUTURE ACADEMIC BUILDING (105,080 gsf)
 F16 - FUTURE ACADEMIC BUILDING (105,080 gsf)
 F17 - FUTURE ACADEMIC BUILDING (105,080 gsf)
 F18 - FUTURE ACADEMIC BUILDING (105,080 gsf)
 F19 - FUTURE ACADEMIC BUILDING (105,080 gsf)
 F20 - FUTURE ACADEMIC BUILDING (105,080 gsf)
 F21 - FUTURE ACADEMIC BUILDING (105,080 gsf)
 F22 - FUTURE ACADEMIC BUILDING (105,080 gsf)
 F23 - FUTURE ACADEMIC BUILDING (105,080 gsf)
 F24 - FUTURE ACADEMIC BUILDING (105,080 gsf)
 F25 - FUTURE ACADEMIC BUILDING (105,080 gsf)
 F26 - FUTURE ACADEMIC BUILDING (105,080 gsf)
 F27 - FUTURE ACADEMIC BUILDING (105,080 gsf)



SITE LOCATION
PRAIRIE VIEW ARM UNIVERSITY
100 ENERGY WAY SUITE 1000
FORT WORTH, TX 76102
817.437.4381



**BURNS
& MCDONNELL**
100 ENERGY WAY SUITE 1000
FORT WORTH, TX 76102
817.437.4381



**PRAIRIE VIEW
A&M UNIVERSITY**

DATE: 05/24/2017
DESIGNED: PKY
CHECKED: PKY
PROJECT: PKY
ATTN: PKY

2017 UTILITY MASTER PLAN
UTILITY ADDITIONS CORRIDOR
BASE CASE PHAS 3 TEAM 5 CHILLED WATER

Project: 98470
Drawing: **SK4** - 0

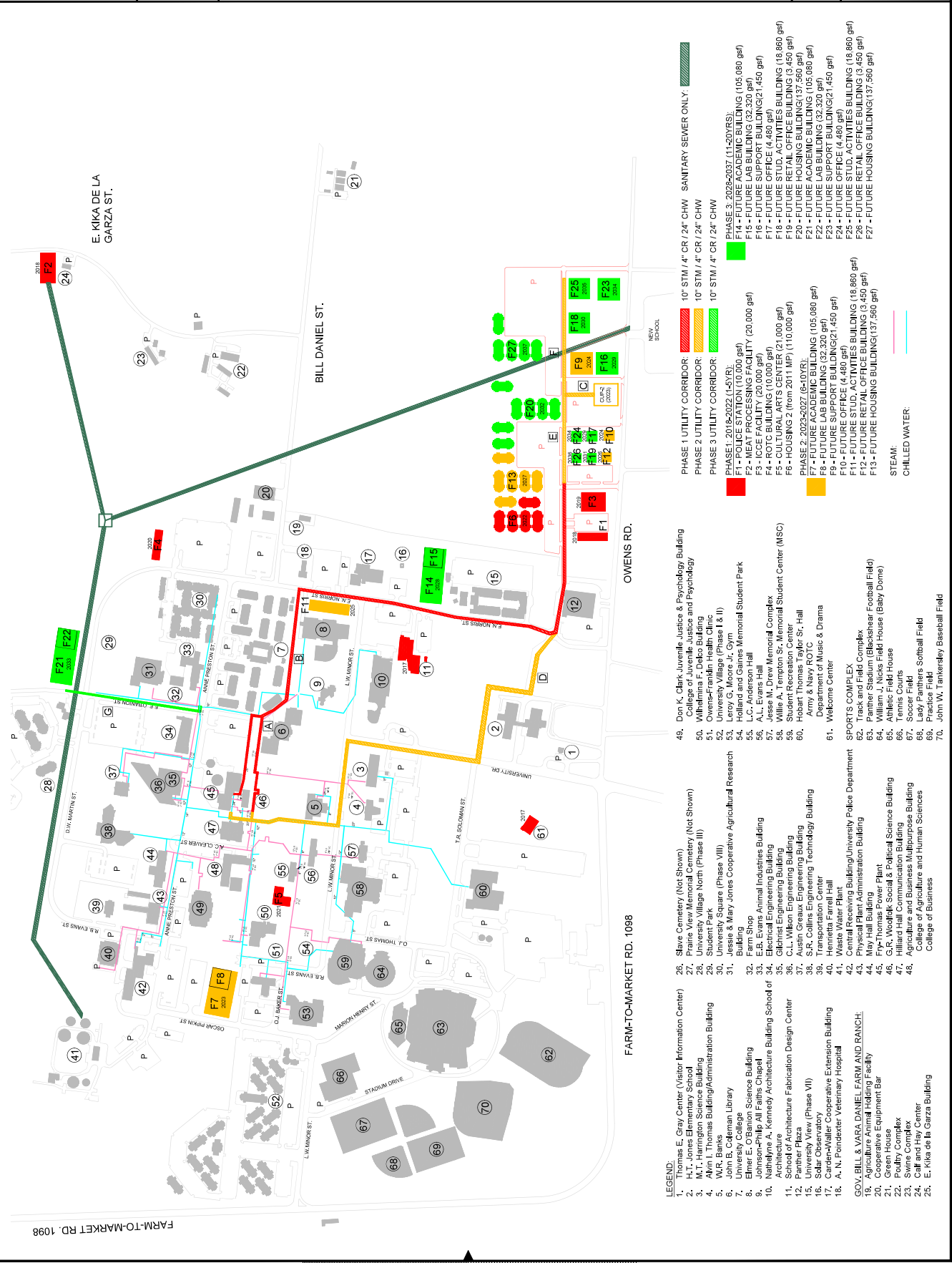

- LEGEND:**
- 1. Thomas E. Gray Center (Visitor Information Center)
 - 2. H.T. Jones Elementary School
 - 3. M.T. Harrington Science Building
 - 4. W.P. Thomas Building/Administration Building
 - 5. Student Plaza
 - 6. John B. Coleman Library
 - 7. University College
 - 8. Elmer E. O'Bannon Science Building
 - 9. Johnson-Philo All Faiths Chapel
 - 10. Natheiyne A. Kennedy Architecture Building School of Architecture
 - 11. Architecture Fabrication Design Center
 - 12. Pattern Plaza
 - 13. University View (Phase VII)
 - 14. Carden-Walker Cooperative Veterinary Hospital
 - 15. A. N. Ponder Veterinary Hospital
 - 16. A. N. Ponder Veterinary Hospital
 - 17. Carden-Walker Cooperative Veterinary Hospital
 - 18. A. N. Ponder Veterinary Hospital
 - 19. A. N. Ponder Veterinary Hospital
 - 20. Cooperative Equipment Bar
 - 21. Green House
 - 22. Poultry Complex
 - 23. Swine Complex
 - 24. Calf and Hay Center
 - 25. E. Kika de la Garza Building
 - 26. Slave Cemetery (Not Shown)
 - 27. Prairie View Memorial Cemetery (Not Shown)
 - 28. Student Park
 - 29. Student Center (Phase VIII)
 - 30. Student Center (Phase VIII)
 - 31. Jesse & Mary Jones Cooperative Agricultural Research Building
 - 32. Farm Shop
 - 33. E.B. Evans Animal Industries Building
 - 34. Electrical Engineering Building
 - 35. Gilbert Engineering Building
 - 36. C.L. Wilson Engineering Building
 - 37. S.P. Collins Engineering Technology Building
 - 38. Transportation Center
 - 39. Henrietta Farrell Hall
 - 40. Waste Water Plant
 - 41. Central Receiving Building/University Police Department
 - 42. Physical Plant Administration Building
 - 43. Physical Plant Administration Building
 - 44. Physical Plant Administration Building
 - 45. G.R. Woodfolk Social & Political Science Building
 - 46. G.R. Woodfolk Social & Political Science Building
 - 47. Hilliard Hall Communication Building
 - 48. Agriculture and Business Multipurpose Building
 - 49. College of Agriculture and Human Sciences
 - 50. College of Business
 - 51. College of Business
 - 52. Track and Field Complex
 - 53. Panther Stadium (Blackshear Football Field)
 - 54. Yehliu Student House (Baby Dome)
 - 55. Athletic Field House
 - 56. Athletic Field House
 - 57. Tennis Courts
 - 58. Soccer Field
 - 59. Soccer Field
 - 60. Practice Field
 - 61. John W. Tankersley Baseball Field
 - 62. Don K. Clark Juvenile Justice & Psychology Building
 - 63. College of Juvenile Justice and Psychology
 - 64. Wilhelmina F. Debo Building
 - 65. Owens-Franklin Health Clinic
 - 66. Lora G. Moore Jr. Gym (A & I)
 - 67. Lora G. Moore Jr. Gym (A & I)
 - 68. Holland and Gaines Memorial Student Park
 - 69. A.L. Evans Hall
 - 70. L.C. Anderson Hall
 - 71. Jesse M. Drew Memorial Complex
 - 72. Willie A. Templeton Sr. Memorial Student Center (MSC)
 - 73. Student Recreation Center
 - 74. Army & Navy ROTC
 - 75. Department of Music & Drama
 - 76. Welcome Center
 - 77. Sports Complex
 - 78. Track and Field Complex
 - 79. Panther Stadium (Blackshear Football Field)
 - 80. Yehliu Student House (Baby Dome)
 - 81. Athletic Field House
 - 82. Tennis Courts
 - 83. Soccer Field
 - 84. Soccer Field
 - 85. Practice Field
 - 86. John W. Tankersley Baseball Field

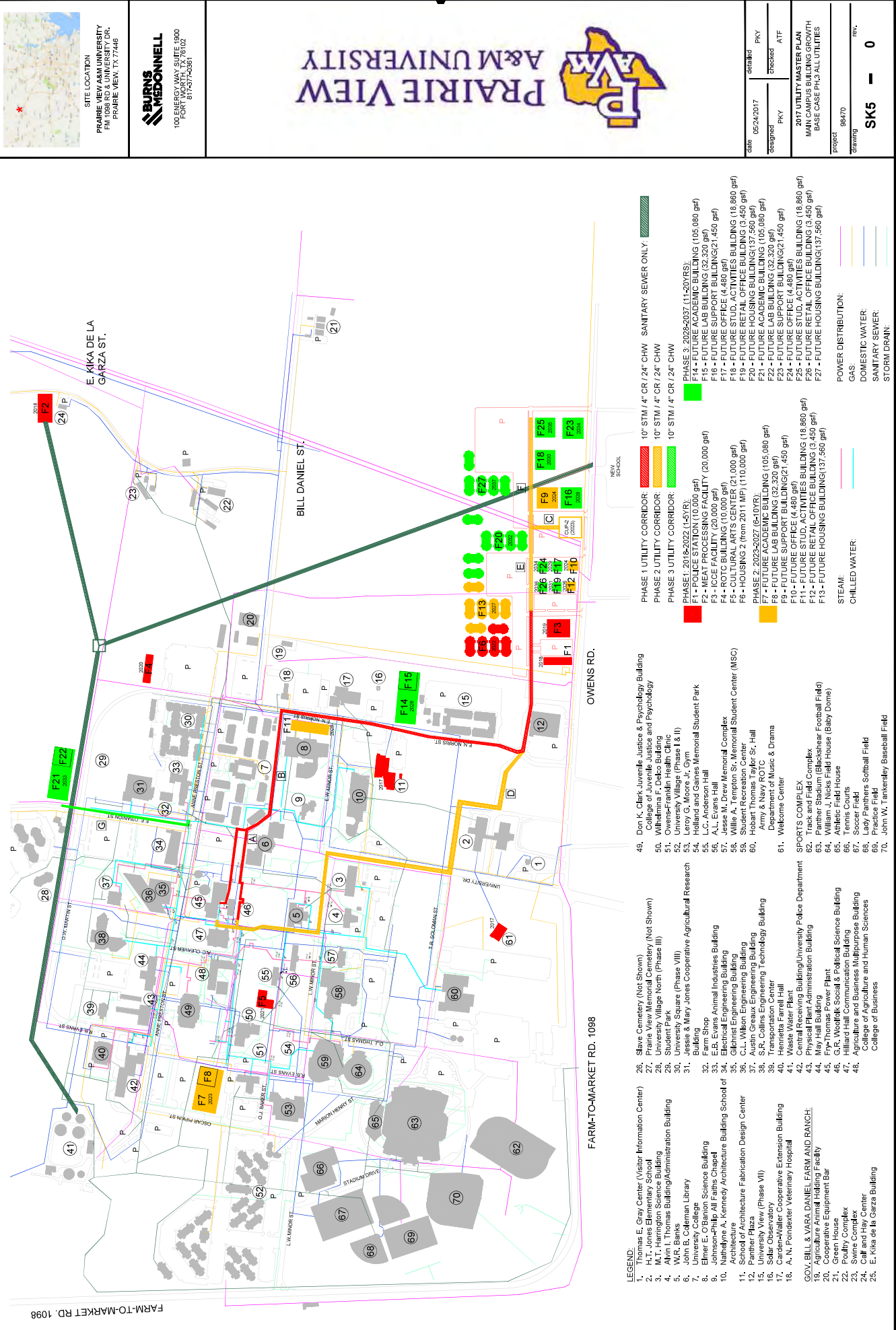

SITE LOCATION
 PRAIRIE VIEW A&M UNIVERSITY
 100 ENERGY WAY, SUITE 1000
 FORT WORTH, TX 76102
 817.437.4361

BURNS & MCDONNELL
 100 ENERGY WAY, SUITE 1000
 FORT WORTH, TX 76102
 817.437.4361



DATE	05/24/2017	PKY	PKY
DESIGNED		CHECKED	ATF
2017 UTILITY MASTER PLAN MAIN CAMPUS BUILDING-GROWTH BASE CASE PHASE ALL UTILITIES			
PROJECT	98470	REV.	
DRAWING	SK5		0

1 2 3 4 5 6 7 8 9 10 11 12 13 14

FARM-TO-MARKET RD. 1098

E. KIKA DE LA GARZA ST.

BILL DANIEL ST.

OWENS RD.

FARM-TO-MARKET RD. 1098

- LEGEND:**
- 1. Thomas E. Gray Center (Visitor Information Center)
 - 2. H.T. Jones Elementary School
 - 3. M.T. Harrington Science Building
 - 4. W.P. Thomas Building/Administration Building
 - 5. Student Center
 - 6. John B. Coleman Library
 - 7. University College
 - 8. Elmer E. O'Bannon Science Building
 - 9. Johnson-Philo All Faiths Chapel
 - 10. Nathefayne A. Kennedy Architecture Building School of Architecture
 - 11. Architecture Fabrication Design Center
 - 12. Patrice Plaza
 - 13. University View (Phase VII)
 - 14. Carden-Walker Cooperative Veterinary Hospital
 - 15. A. N. Ponder Veterinary Hospital
 - 16. A. N. Ponder Veterinary Hospital
 - 17. A. N. Ponder Veterinary Hospital
 - 18. A. N. Ponder Veterinary Hospital
 - 19. A. N. Ponder Veterinary Hospital
 - 20. A. N. Ponder Veterinary Hospital
 - 21. A. N. Ponder Veterinary Hospital
 - 22. A. N. Ponder Veterinary Hospital
 - 23. A. N. Ponder Veterinary Hospital
 - 24. A. N. Ponder Veterinary Hospital
 - 25. A. N. Ponder Veterinary Hospital
 - 26. Slave Cemetery (Not Shown)
 - 27. Prairie View Memorial Cemetery (Not Shown)
 - 28. Student Village North (Phase III)
 - 29. Student Village South (Phase III)
 - 30. Student Village East (Phase III)
 - 31. Student Village West (Phase III)
 - 32. Farm Shop
 - 33. E.B. Evans Animal Industries Building
 - 34. Electrical Engineering Building
 - 35. Chemical Engineering Building
 - 36. C.L. Wilson Engineering Building
 - 37. S.P. Collins Engineering Technology Building
 - 38. Transportation Center
 - 39. Henrietta Farrell Hall
 - 40. Waste Water Plant
 - 41. Central Receiving Building/University Police Department
 - 42. Physical Plant Administration Building
 - 43. Physical Plant Administration Building
 - 44. Physical Plant Administration Building
 - 45. Physical Plant Administration Building
 - 46. G.R. Woodfolk Social & Political Science Building
 - 47. Hilliard Hall Communication Building
 - 48. Agriculture and Business Multipurpose Building
 - 49. College of Agriculture and Human Sciences
 - 50. College of Business
 - 51. College of Business
 - 52. Track and Field Complex
 - 53. Janner Stadium (Blackshear Football Field)
 - 54. Janner Stadium (Blackshear Football Field)
 - 55. Athletic Field House (Baby Dome)
 - 56. Athletic Field House
 - 57. Tennis Courts
 - 58. Soccer Field
 - 59. Lady Panthers Softball Field
 - 60. Practice Field
 - 61. John W. Tankersley Baseball Field
 - 62. Don K. Clark Juvenile Justice & Psychology Building
 - 63. College of Juvenile Justice and Psychology
 - 64. Wilhelmina F. Debo Building
 - 65. Owers-Franklin Health Clinic
 - 66. Laron G. Moore Jr. Gym (I & II)
 - 67. Holland and Gaines Memorial Student Park
 - 68. L.C. Anderson Hall
 - 69. A.L. Evans Hall
 - 70. Jesse M. Drew Memorial Complex
 - 71. Willie A. Tompkins Sr. Memorial Student Center (MSC)
 - 72. Student Recreation Center
 - 73. Student Recreation Center
 - 74. Army & Navy ROTC
 - 75. Department of Music & Drama
 - 76. Welcome Center
 - 77. Sports Complex
 - 78. Track and Field Complex
 - 79. Janner Stadium (Blackshear Football Field)
 - 80. Janner Stadium (Blackshear Football Field)
 - 81. Athletic Field House (Baby Dome)
 - 82. Athletic Field House
 - 83. Tennis Courts
 - 84. Soccer Field
 - 85. Lady Panthers Softball Field
 - 86. Practice Field
 - 87. John W. Tankersley Baseball Field
- PHASE 1 UTILITY CORRIDOR:** 10" STM / 4" CR / 24" CHW SANITARY SEWER ONLY.
 10" STM / 4" CR / 24" CHW
 10" STM / 4" CR / 24" CHW
- PHASE 2 UTILITY CORRIDOR:** 10" STM / 4" CR / 24" CHW
 10" STM / 4" CR / 24" CHW
- PHASE 3 UTILITY CORRIDOR:** 10" STM / 4" CR / 24" CHW
- PHASE 1, 2018-2022 (15-YR):**
 F1 - POLICE STATION (10,000 gsf)
 F2 - MEAT PROCESSING FACILITY (20,000 gsf)
 F3 - ROTC BUILDING (10,000 gsf)
 F4 - ROTC BUILDING (10,000 gsf)
 F5 - CULTURAL ARTS CENTER (21,000 gsf)
 F6 - HOUSING 2 (from 2011 MP) (110,000 gsf)
 F7 - FUTURE ACADEMIC BUILDING (105,080 gsf)
 F8 - FUTURE STUD. ACTIVITIES BUILDING (18,860 gsf)
 F9 - FUTURE STUD. ACTIVITIES BUILDING (18,860 gsf)
 F10 - FUTURE STUD. ACTIVITIES BUILDING (18,860 gsf)
 F11 - FUTURE STUD. ACTIVITIES BUILDING (18,860 gsf)
 F12 - FUTURE STUD. ACTIVITIES BUILDING (18,860 gsf)
 F13 - FUTURE STUD. ACTIVITIES BUILDING (18,860 gsf)
 F14 - FUTURE STUD. ACTIVITIES BUILDING (18,860 gsf)
 F15 - FUTURE STUD. ACTIVITIES BUILDING (18,860 gsf)
 F16 - FUTURE STUD. ACTIVITIES BUILDING (18,860 gsf)
 F17 - FUTURE STUD. ACTIVITIES BUILDING (18,860 gsf)
 F18 - FUTURE STUD. ACTIVITIES BUILDING (18,860 gsf)
 F19 - FUTURE STUD. ACTIVITIES BUILDING (18,860 gsf)
 F20 - FUTURE STUD. ACTIVITIES BUILDING (18,860 gsf)
 F21 - FUTURE STUD. ACTIVITIES BUILDING (18,860 gsf)
 F22 - FUTURE STUD. ACTIVITIES BUILDING (18,860 gsf)
 F23 - FUTURE STUD. ACTIVITIES BUILDING (18,860 gsf)
 F24 - FUTURE STUD. ACTIVITIES BUILDING (18,860 gsf)
 F25 - FUTURE STUD. ACTIVITIES BUILDING (18,860 gsf)
 F26 - FUTURE STUD. ACTIVITIES BUILDING (18,860 gsf)
 F27 - FUTURE STUD. ACTIVITIES BUILDING (18,860 gsf)
- PHASE 2, 2023-2027 (6-10 YR):**
 F28 - FUTURE STUD. ACTIVITIES BUILDING (18,860 gsf)
 F29 - FUTURE STUD. ACTIVITIES BUILDING (18,860 gsf)
 F30 - FUTURE STUD. ACTIVITIES BUILDING (18,860 gsf)
 F31 - FUTURE STUD. ACTIVITIES BUILDING (18,860 gsf)
 F32 - FUTURE STUD. ACTIVITIES BUILDING (18,860 gsf)
 F33 - FUTURE STUD. ACTIVITIES BUILDING (18,860 gsf)
 F34 - FUTURE STUD. ACTIVITIES BUILDING (18,860 gsf)
 F35 - FUTURE STUD. ACTIVITIES BUILDING (18,860 gsf)
 F36 - FUTURE STUD. ACTIVITIES BUILDING (18,860 gsf)
 F37 - FUTURE STUD. ACTIVITIES BUILDING (18,860 gsf)
 F38 - FUTURE STUD. ACTIVITIES BUILDING (18,860 gsf)
 F39 - FUTURE STUD. ACTIVITIES BUILDING (18,860 gsf)
 F40 - FUTURE STUD. ACTIVITIES BUILDING (18,860 gsf)
 F41 - FUTURE STUD. ACTIVITIES BUILDING (18,860 gsf)
 F42 - FUTURE STUD. ACTIVITIES BUILDING (18,860 gsf)
 F43 - FUTURE STUD. ACTIVITIES BUILDING (18,860 gsf)
 F44 - FUTURE STUD. ACTIVITIES BUILDING (18,860 gsf)
 F45 - FUTURE STUD. ACTIVITIES BUILDING (18,860 gsf)
 F46 - FUTURE STUD. ACTIVITIES BUILDING (18,860 gsf)
 F47 - FUTURE STUD. ACTIVITIES BUILDING (18,860 gsf)
 F48 - FUTURE STUD. ACTIVITIES BUILDING (18,860 gsf)
 F49 - FUTURE STUD. ACTIVITIES BUILDING (18,860 gsf)
 F50 - FUTURE STUD. ACTIVITIES BUILDING (18,860 gsf)
 F51 - FUTURE STUD. ACTIVITIES BUILDING (18,860 gsf)
 F52 - FUTURE STUD. ACTIVITIES BUILDING (18,860 gsf)
 F53 - FUTURE STUD. ACTIVITIES BUILDING (18,860 gsf)
 F54 - FUTURE STUD. ACTIVITIES BUILDING (18,860 gsf)
 F55 - FUTURE STUD. ACTIVITIES BUILDING (18,860 gsf)
 F56 - FUTURE STUD. ACTIVITIES BUILDING (18,860 gsf)
 F57 - FUTURE STUD. ACTIVITIES BUILDING (18,860 gsf)
 F58 - FUTURE STUD. ACTIVITIES BUILDING (18,860 gsf)
 F59 - FUTURE STUD. ACTIVITIES BUILDING (18,860 gsf)
 F60 - FUTURE STUD. ACTIVITIES BUILDING (18,860 gsf)
 F61 - FUTURE STUD. ACTIVITIES BUILDING (18,860 gsf)
 F62 - FUTURE STUD. ACTIVITIES BUILDING (18,860 gsf)
 F63 - FUTURE STUD. ACTIVITIES BUILDING (18,860 gsf)
 F64 - FUTURE STUD. ACTIVITIES BUILDING (18,860 gsf)
 F65 - FUTURE STUD. ACTIVITIES BUILDING (18,860 gsf)
 F66 - FUTURE STUD. ACTIVITIES BUILDING (18,860 gsf)
 F67 - FUTURE STUD. ACTIVITIES BUILDING (18,860 gsf)
 F68 - FUTURE STUD. ACTIVITIES BUILDING (18,860 gsf)
 F69 - FUTURE STUD. ACTIVITIES BUILDING (18,860 gsf)
 F70 - FUTURE STUD. ACTIVITIES BUILDING (18,860 gsf)
- PHASE 3, 2028-2037 (11-20 YRS):**
 F71 - FUTURE STUD. ACTIVITIES BUILDING (18,860 gsf)
 F72 - FUTURE STUD. ACTIVITIES BUILDING (18,860 gsf)
 F73 - FUTURE STUD. ACTIVITIES BUILDING (18,860 gsf)
 F74 - FUTURE STUD. ACTIVITIES BUILDING (18,860 gsf)
 F75 - FUTURE STUD. ACTIVITIES BUILDING (18,860 gsf)
 F76 - FUTURE STUD. ACTIVITIES BUILDING (18,860 gsf)
 F77 - FUTURE STUD. ACTIVITIES BUILDING (18,860 gsf)
 F78 - FUTURE STUD. ACTIVITIES BUILDING (18,860 gsf)
 F79 - FUTURE STUD. ACTIVITIES BUILDING (18,860 gsf)
 F80 - FUTURE STUD. ACTIVITIES BUILDING (18,860 gsf)
 F81 - FUTURE STUD. ACTIVITIES BUILDING (18,860 gsf)
 F82 - FUTURE STUD. ACTIVITIES BUILDING (18,860 gsf)
 F83 - FUTURE STUD. ACTIVITIES BUILDING (18,860 gsf)
 F84 - FUTURE STUD. ACTIVITIES BUILDING (18,860 gsf)
 F85 - FUTURE STUD. ACTIVITIES BUILDING (18,860 gsf)
 F86 - FUTURE STUD. ACTIVITIES BUILDING (18,860 gsf)
 F87 - FUTURE STUD. ACTIVITIES BUILDING (18,860 gsf)
 F88 - FUTURE STUD. ACTIVITIES BUILDING (18,860 gsf)
 F89 - FUTURE STUD. ACTIVITIES BUILDING (18,860 gsf)
 F90 - FUTURE STUD. ACTIVITIES BUILDING (18,860 gsf)
 F91 - FUTURE STUD. ACTIVITIES BUILDING (18,860 gsf)
 F92 - FUTURE STUD. ACTIVITIES BUILDING (18,860 gsf)
 F93 - FUTURE STUD. ACTIVITIES BUILDING (18,860 gsf)
 F94 - FUTURE STUD. ACTIVITIES BUILDING (18,860 gsf)
 F95 - FUTURE STUD. ACTIVITIES BUILDING (18,860 gsf)
 F96 - FUTURE STUD. ACTIVITIES BUILDING (18,860 gsf)
 F97 - FUTURE STUD. ACTIVITIES BUILDING (18,860 gsf)
 F98 - FUTURE STUD. ACTIVITIES BUILDING (18,860 gsf)
 F99 - FUTURE STUD. ACTIVITIES BUILDING (18,860 gsf)
 F100 - FUTURE STUD. ACTIVITIES BUILDING (18,860 gsf)
- POWER DISTRIBUTION:**
 GAS
 DOMESTIC WATER
 SANITARY SEWER
 STORM DRAIN
- STEAM:**
 CHILLED WATER



SITE LOCATION
 PRAIRIE VIEW A&M UNIVERSITY
 100 ENERGY WAY SUITE 1000
 FARM TO MARKET RD.
 PRAIRIE VIEW, TX 77446



BURNS & MCDONNELL
 100 ENERGY WAY SUITE 1000
 FARM TO MARKET RD.
 PRAIRIE VIEW, TX 77446
 817.437.4381

PRAIRIE VIEW A&M UNIVERSITY



DATE	05/24/2017	PKY	PKY
DESIGNED	PKY	CHECKED	ATF
2017 UTILITY MASTER PLAN			
OPTION 2 UTILITY ADDITIONS CORRIDOR			
PROJECT	98470	REV.	
DRAWING			
SK6		0	

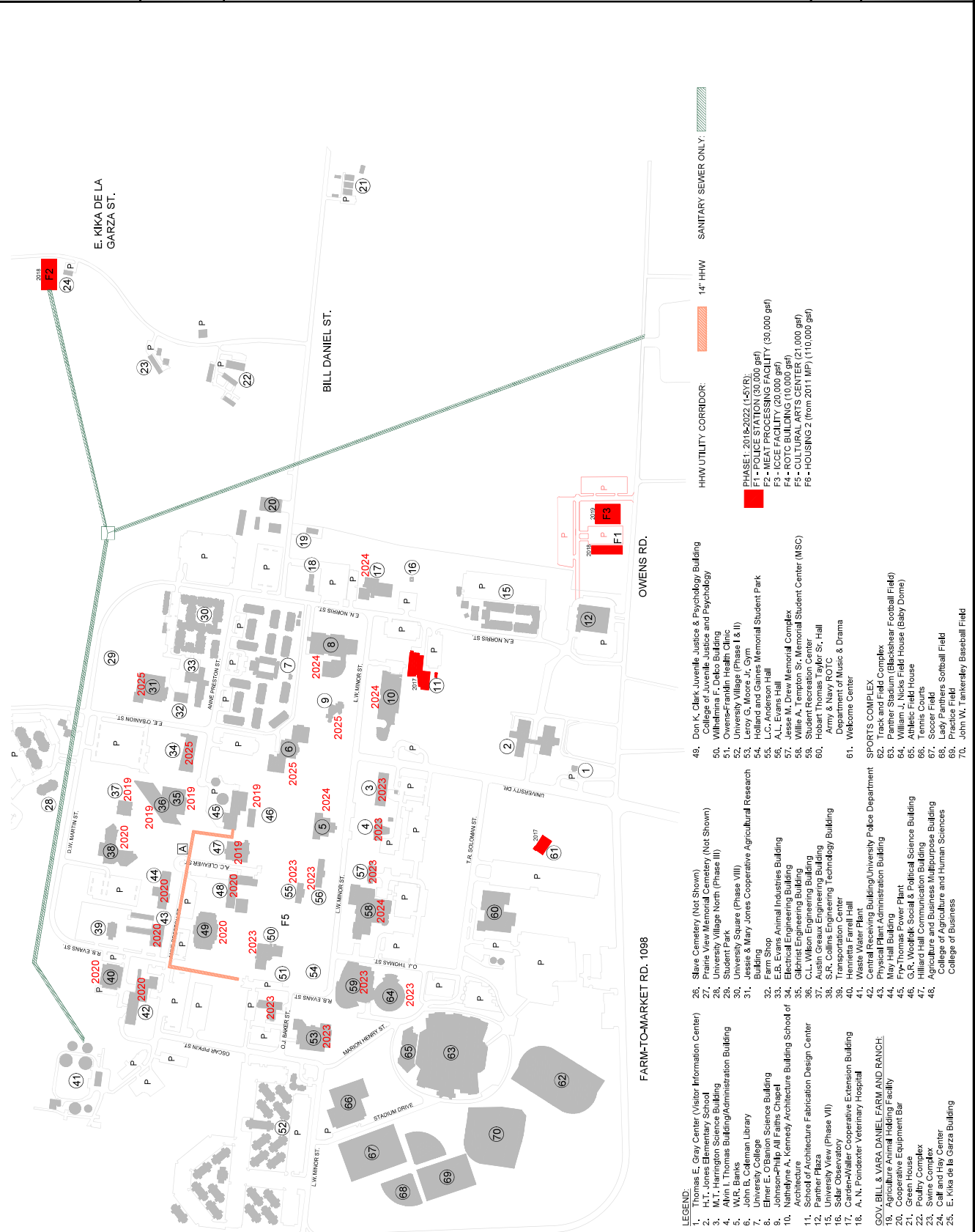

- LEGEND:**
- 1. Thomas E. Gray Center (Visitor Information Center)
 - 2. H.T. Jones Elementary School
 - 3. M.T. Harrington Science Building
 - 4. W.P. Thomas Building/Administration Building
 - 5. Student Center
 - 6. John B. Coleman Library
 - 7. University College
 - 8. Elmer E. O'Bannon Science Building
 - 9. Johnson-Philip All Faiths Chapel
 - 10. Natheiyne A. Kennedy Architecture Building School of Architecture
 - 11. Architecture Fabrication Design Center
 - 12. Panther Plaza
 - 13. University View (Phase VII)
 - 14. Solar Observatory
 - 15. Carden-Waller Cooperative Veterinary Hospital
 - 16. A. N. Poindbexter Veterinary Hospital
 - 17. A. N. Poindbexter Veterinary Hospital
 - 18. A. N. Poindbexter Veterinary Hospital
 - 19. A. N. Poindbexter Veterinary Hospital
 - 20. A. N. Poindbexter Veterinary Hospital
 - 21. A. N. Poindbexter Veterinary Hospital
 - 22. A. N. Poindbexter Veterinary Hospital
 - 23. A. N. Poindbexter Veterinary Hospital
 - 24. A. N. Poindbexter Veterinary Hospital
 - 25. A. N. Poindbexter Veterinary Hospital
 - 26. Slave Cemetery (Not Shown)
 - 27. Prairie View Memorial Cemetery (Not Shown)
 - 28. University Village North (Phase III)
 - 29. Student Park
 - 30. University Village South (Phase I & II)
 - 31. Jesse & Mary Jones Cooperative Agricultural Research Building
 - 32. Farm Shop
 - 33. E.B. Evans Animal Industries Building
 - 34. Electrical Engineering Building
 - 35. Gilbert Engineering Building
 - 36. C.L. Wilson Engineering Building
 - 37. S.F. Collins Engineering Technology Building
 - 38. Transportation Center
 - 39. Henrietta Farrell Hall
 - 40. Waste Water Plant
 - 41. Central Receiving Building/University Police Department
 - 42. Physical Plant Administration Building
 - 43. Physical Plant Administration Building
 - 44. Physical Plant Administration Building
 - 45. G.R. Woodfolk Social & Political Science Building
 - 46. Hilliard Hall Communication Building
 - 47. Hilliard Hall Communication Building
 - 48. Agriculture and Business Multipurpose Building
 - 49. College of Agriculture and Human Sciences
 - 50. College of Agriculture and Human Sciences
 - 51. College of Agriculture and Human Sciences
 - 52. College of Agriculture and Human Sciences
 - 53. College of Agriculture and Human Sciences
 - 54. College of Agriculture and Human Sciences
 - 55. College of Agriculture and Human Sciences
 - 56. College of Agriculture and Human Sciences
 - 57. College of Agriculture and Human Sciences
 - 58. College of Agriculture and Human Sciences
 - 59. College of Agriculture and Human Sciences
 - 60. College of Agriculture and Human Sciences
 - 61. College of Agriculture and Human Sciences
 - 62. Track and Field Complex
 - 63. Panther Stadium (Blackshear Football Field)
 - 64. Youth Center and House (Baby Dome)
 - 65. Athletic Field House
 - 66. Tennis Courts
 - 67. Soccer Field
 - 68. Lady Panthers Softball Field
 - 69. Practice Field
 - 70. John W. Tankersley Baseball Field

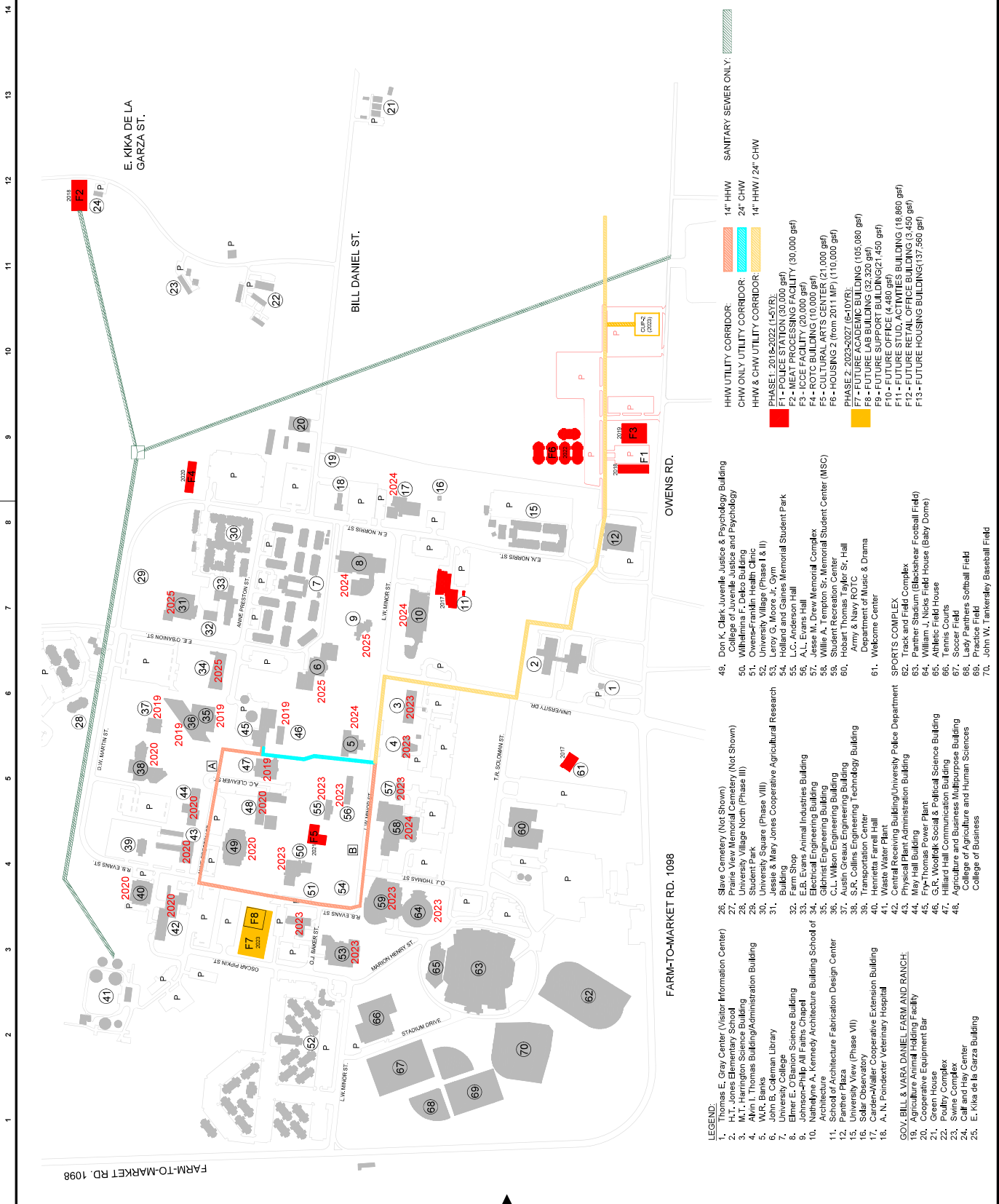

SITE LOCATION
 PRAIRIE VIEW A&M UNIVERSITY
 100 ENERGY WAY SUITE 1000
 FARM TO MARKET RD.
 PRAIRIE VIEW, TX 77446

BURNS & MCDONNELL
 100 ENERGY WAY SUITE 1000
 FARM TO MARKET RD.
 PRAIRIE VIEW, TX 77446
 817-437-4361



DATE	05/24/2017	PKY	PKY
DESIGNED	PKY	CHECKED	ATF
2017 UTILITY MASTER PLAN OPTION 2 UTILITY ADDITIONS CORRIDOR YEAR 2025			
PROJECT	98470	REV.	
DRAWING			
SK7		- 0	

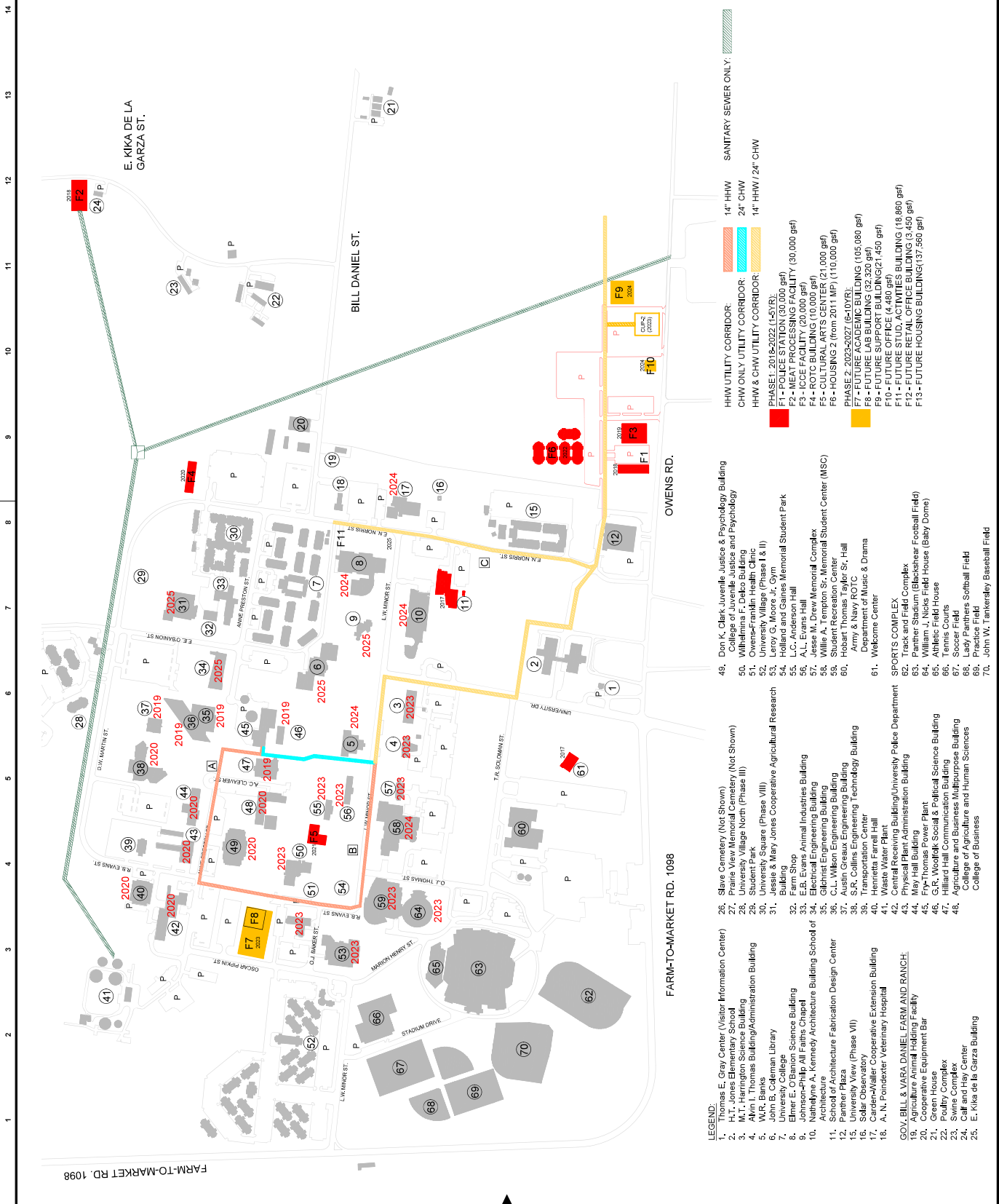

SITE LOCATION
 PRAIRIE VIEW A&M UNIVERSITY
 100 ENERGYWAY SUITE 1000
 FORT WORTH, TX 76102
 PRRAIRIE VIEW, TX 77446



PRAIRIE VIEW A&M UNIVERSITY



- LEGEND:**
- 1. Thomas E. Gray Center (Visitor Information Center)
 - 2. H.T. Jones Elementary School
 - 3. M.T. Harrington Science Building
 - 4. W.P. Thomas Building/Administration Building
 - 5. Student Center (Phase VIII)
 - 6. John B. Coleman Library
 - 7. University College
 - 8. Elmer E. O'Bannon Science Building
 - 9. Johnson-Philip All Faiths Chapel
 - 10. Natheiyne A. Kennedy Architecture Building School of Architecture
 - 11. Architecture Fabrication Design Center
 - 12. Panther Plaza
 - 13. University View (Phase VII)
 - 14. Solar Observatory
 - 15. Carden-Walker Cooperative Extension Building
 - 16. A. N. Poindecker Veterinary Hospital
 - 17. A. N. Poindecker Veterinary Hospital
 - 18. A. N. Poindecker Veterinary Hospital
 - 19. A. N. Poindecker Veterinary Hospital
 - 20. A. N. Poindecker Veterinary Hospital
 - 21. A. N. Poindecker Veterinary Hospital
 - 22. A. N. Poindecker Veterinary Hospital
 - 23. A. N. Poindecker Veterinary Hospital
 - 24. A. N. Poindecker Veterinary Hospital
 - 25. A. N. Poindecker Veterinary Hospital
 - 26. Slave Cemetery (Not Shown)
 - 27. Prairie View Memorial Cemetery (Not Shown)
 - 28. University Village North (Phase III)
 - 29. Student Park
 - 30. Student Center (Phase VIII)
 - 31. Student Center (Phase VIII)
 - 32. Farm Shop
 - 33. E.B. Evans Animal Industries Building
 - 34. Electrical Engineering Building
 - 35. Chemical Engineering Building
 - 36. C.L. Wilson Engineering Building
 - 37. S.F. Collins Engineering Technology Building
 - 38. Transportation Center
 - 39. Henrietta Farrell Hall
 - 40. Waste Water Plant
 - 41. Central Receiving Building/University Police Department
 - 42. Physical Plant Administration Building
 - 43. Physical Plant Administration Building
 - 44. Physical Plant Administration Building
 - 45. Physical Plant Administration Building
 - 46. G.R. Woodfolk Social & Political Science Building
 - 47. Hilliard Hall Communication Building
 - 48. Agriculture and Business Multipurpose Building
 - 49. College of Agriculture and Human Sciences
 - 50. College of Agriculture and Human Sciences
 - 51. College of Agriculture and Human Sciences
 - 52. College of Agriculture and Human Sciences
 - 53. College of Agriculture and Human Sciences
 - 54. College of Agriculture and Human Sciences
 - 55. College of Agriculture and Human Sciences
 - 56. College of Agriculture and Human Sciences
 - 57. College of Agriculture and Human Sciences
 - 58. College of Agriculture and Human Sciences
 - 59. College of Agriculture and Human Sciences
 - 60. College of Agriculture and Human Sciences
 - 61. College of Agriculture and Human Sciences
 - 62. Track and Field Complex
 - 63. Panther Stadium (Blackshear Football Field)
 - 64. Y.M.C.A. Field House (Baby Dome)
 - 65. Athletic Field House
 - 66. Tennis Courts
 - 67. Soccer Field
 - 68. Lady Panthers Softball Field
 - 69. Practice Field
 - 70. John W. Tankersley Baseball Field

DATE	DESIGNED	CHECKED	PKY
05/24/2017			

DATE	DESIGNED	CHECKED	PKY
05/24/2017			

2017 UTILITY MASTER PLAN
 OPTION 2 UTILITY ADDITIONS CORRIDOR
 YEAR 2024

Project: 98470
 Drawing: rev. 0

SK8 - 0

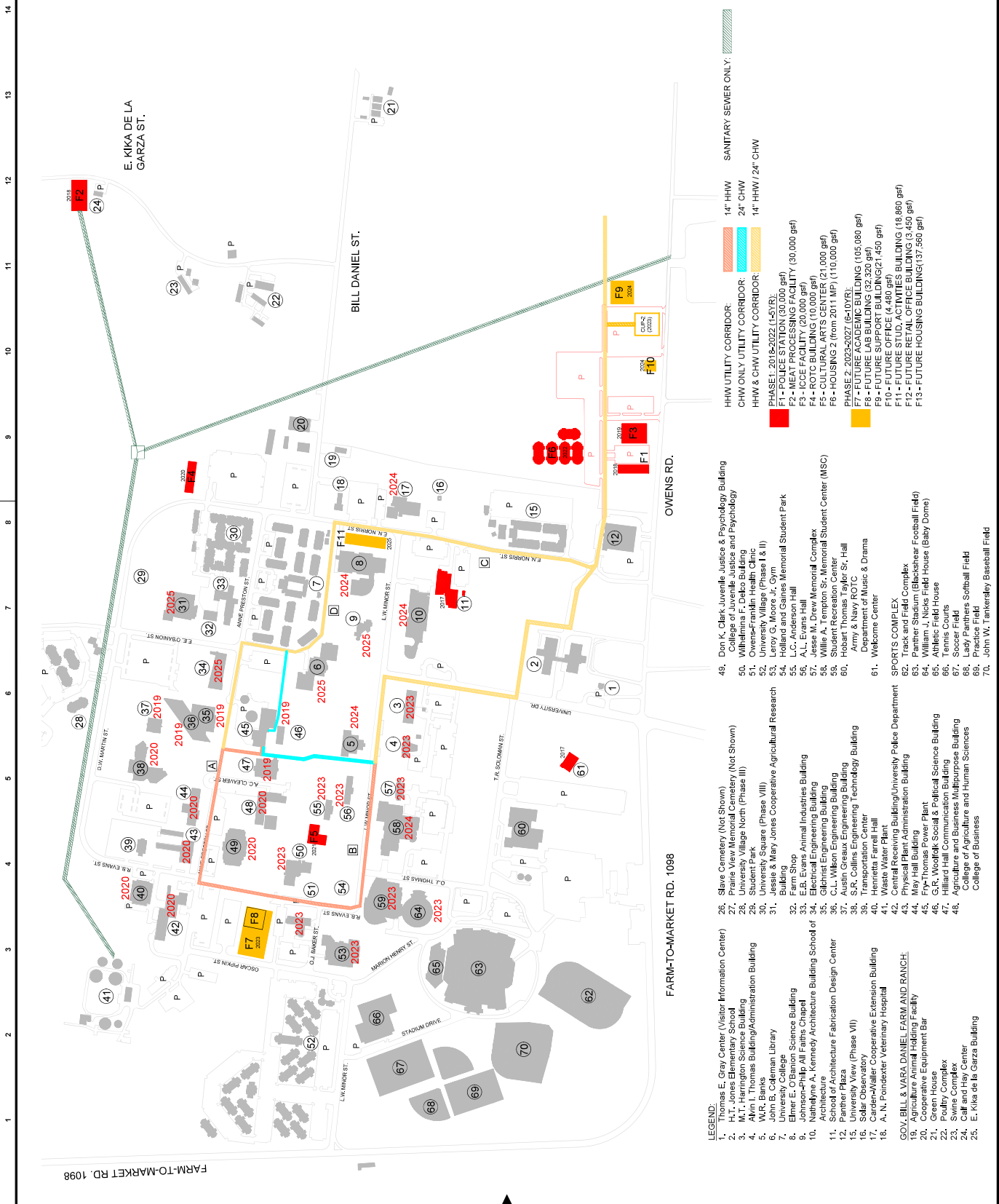

SITE LOCATION
 PRAIRIE VIEW A&M UNIVERSITY
 100 ENERGY WAY SUITE 1000
 FORT WORTH, TX 76102
 PRAIRIE VIEW, TX 77446



PRAIRIE VIEW A&M UNIVERSITY



DATE	05/24/2017	PKY	PKY
DESIGNED		PKY	PKY
CHECKED		ATF	ATF
2017 UTILITY MASTER PLAN			
OPTION 2 UTILITY ADDITIONS CORRIDOR			
YEAR 2025			
PROJECT	98470	REV.	
DRAWING			
SK9		- 0	

- LEGEND:**
- 1. Thomas E. Gray Center (Visitor Information Center)
 - 2. H.T. Jones Elementary School
 - 3. M.T. Harrington Science Building
 - 4. W.P. Thomas Building/Administration Building
 - 5. Student Center (Phase VIII)
 - 6. John B. Coleman Library
 - 7. University College
 - 8. Elmer E. O'Bannon Science Building
 - 9. Johnson-Philip All Faiths Chapel
 - 10. Natheiyne A. Kennedy Architecture Building School of Architecture
 - 11. Architecture Fabrication Design Center
 - 12. Panther Plaza
 - 13. University View (Phase VII)
 - 14. Solar Observatory
 - 15. Carden-Walker Cooperative Extension Building
 - 16. A. N. Poindeexter Veterinary Hospital
 - 17. A. N. Poindeexter Veterinary Hospital
 - 18. A. N. Poindeexter Veterinary Hospital
 - 19. A. N. Poindeexter Veterinary Hospital
 - 20. A. N. Poindeexter Veterinary Hospital
 - 21. A. N. Poindeexter Veterinary Hospital
 - 22. A. N. Poindeexter Veterinary Hospital
 - 23. A. N. Poindeexter Veterinary Hospital
 - 24. A. N. Poindeexter Veterinary Hospital
 - 25. A. N. Poindeexter Veterinary Hospital

- 26. Slave Cemetery (Not Shown)
- 27. Prairie View Memorial Cemetery (Not Shown)
- 28. University Village North (Phase III)
- 29. Student Park
- 30. University Village (Phase VIII)
- 31. Jesse & Mary Jones Cooperative Agricultural Research Building
- 32. Farm Shop
- 33. E.B. Evans Animal Industries Building
- 34. Electrical Engineering Building
- 35. Chemical Engineering Building
- 36. C.L. Wilson Engineering Building
- 37. S.F. Collins Engineering Technology Building
- 38. Transportation Center
- 39. Henrietta Farrell Hall
- 40. Waste Water Plant
- 41. Central Receiving Building/University Police Department
- 42. Physical Plant Administration Building
- 43. Physical Plant Administration Building
- 44. Physical Plant Administration Building
- 45. Physical Plant Administration Building
- 46. G.R. Woodfolk Social & Political Science Building
- 47. Hilliard Hall Communication Building
- 48. Agriculture and Business Multipurpose Building
- 49. College of Agriculture and Human Sciences
- 50. College of Business
- 51. College of Business
- 52. College of Business
- 53. College of Business
- 54. College of Business
- 55. College of Business
- 56. College of Business
- 57. College of Business
- 58. College of Business
- 59. College of Business
- 60. College of Business
- 61. College of Business
- 62. Track and Field Complex
- 63. Panther Stadium (Blackshear Football Field)
- 64. Y.W. and Y.M. Clubhouse (Baby Dome)
- 65. Athletic Field House
- 66. Tennis Courts
- 67. Soccer Field
- 68. Lady Panthers Softball Field
- 69. Practice Field
- 70. John W. Tankersley Baseball Field

- 49. Don K. Clark Juvenile Justice & Psychology Building
- 50. Wilhelmina F. Debo Building
- 51. Owens-Franklin Health Clinic
- 52. Student Recreation Center (S & I)
- 53. Leroy G. Moore Jr. Gymnasium
- 54. Holland and Gaines Memorial Student Park
- 55. L.C. Anderson Hall
- 56. A.L. Evans Hall
- 57. Jesse M. Drew Memorial Complex
- 58. Willie A. Templeton Sr. Memorial Student Center (MSC)
- 59. Student Recreation Center
- 60. Student Recreation Center
- 61. Department of Music & Drama
- 62. Department of Music & Drama
- 63. Department of Music & Drama
- 64. Department of Music & Drama
- 65. Department of Music & Drama
- 66. Department of Music & Drama
- 67. Department of Music & Drama
- 68. Department of Music & Drama
- 69. Department of Music & Drama
- 70. Department of Music & Drama

- PHASE 1: 2018&2022 (15-YR):
- F1 - POLICE STATION (30,000 gsf)
- F2 - MEAT PROCESSING FACILITY (30,000 gsf)
- F3 - ICCE BUILDING (20,000 gsf)
- F4 - ROTC BUILDING (10,000 gsf)
- F5 - CULTURAL ARTS CENTER (21,000 gsf)
- F6 - HOUSING 2 (from 2011 MP) (110,000 gsf)
- PHASE 2: 2023-2027 (6-10 YR):
- F7 - FUTURE ACADEMIC BUILDING (105,000 gsf)
- F8 - FUTURE SUPPORT BUILDING (21,450 gsf)
- F9 - FUTURE OFFICE (4,480 gsf)
- F10 - FUTURE STUD. ACTIVITIES BUILDING (18,860 gsf)
- F11 - FUTURE RETAIL OFFICE BUILDING (3,450 gsf)
- F12 - FUTURE HOUSING BUILDING (137,560 gsf)

HHW UTILITY CORRIDOR
 CHW ONLY UTILITY CORRIDOR
 HHW & CHW UTILITY CORRIDOR
 SANITARY SEWER ONLY

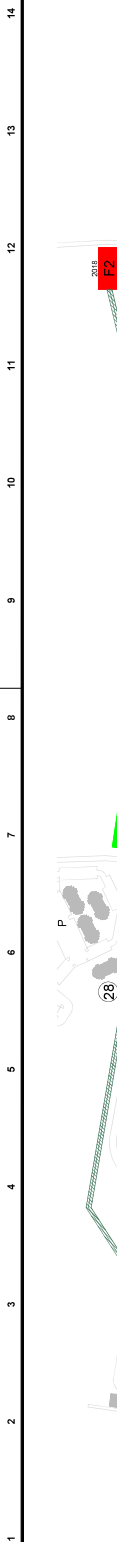

SITE LOCATION
 PRAIRIE VIEW A&M UNIVERSITY
 100 ENERGY WAY SUITE 1000
 FORT WORTH, TX 76102
 PRRAIRIE VIEW, TX 77446

BURNS & MCDONNELL
 100 ENERGY WAY SUITE 1000
 FORT WORTH, TX 76102
 817.437.4381

PRAIRIE VIEW A&M UNIVERSITY

DATE	05/24/2017	PKY	checked
DESIGNED		PKY	checked
2017 UTILITY MASTER PLAN			
OPTION 2 UTILITY ADDITIONS CORRIDOR			
YEAR 2025			
PROJECT	98470		
DRAWING			
			REV.
			0

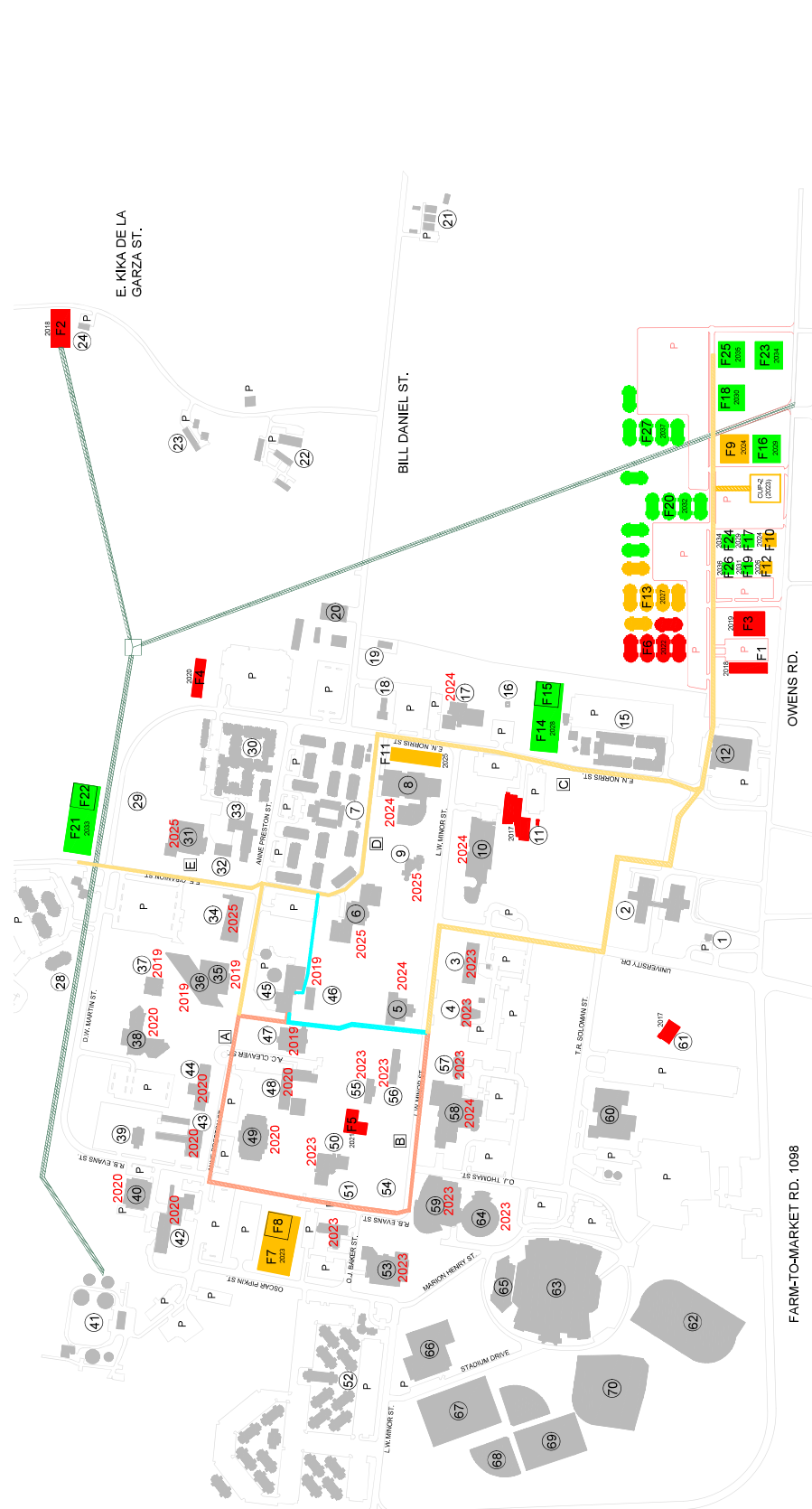

- LEGEND:**
- 1. Thomas E. Gray Center (Visitor Information Center)
 - 2. H.T. Jones Elementary School
 - 3. M.T. Harrington Science Building
 - 4. W.P. Thomas Building/Administration Building
 - 5. Student Plaza
 - 6. John B. Coleman Library
 - 7. University College
 - 8. Elmer E. O'Bannon Science Building
 - 9. Johnson-Philo All Faiths Chapel
 - 10. Natheiyne A. Kennedy Architecture Building School of Architecture
 - 11. Architecture Fabrication Design Center
 - 12. Pattee Plaza
 - 13. University View (Phase VII)
 - 14. Solar Observatory
 - 15. Carden-Walker Cooperative Veterinary Hospital
 - 16. A. N. Ponder Veterinary Hospital
 - 17. A. N. Ponder Veterinary Hospital
 - 18. A. N. Ponder Veterinary Hospital
 - 19. A. N. Ponder Veterinary Hospital
 - 20. A. N. Ponder Veterinary Hospital
 - 21. A. N. Ponder Veterinary Hospital
 - 22. A. N. Ponder Veterinary Hospital
 - 23. A. N. Ponder Veterinary Hospital
 - 24. A. N. Ponder Veterinary Hospital
 - 25. A. N. Ponder Veterinary Hospital
 - 26. Slave Cemetery (Not Shown)
 - 27. Prairie View Memorial Cemetery (Not Shown)
 - 28. University Village North (Phase III)
 - 29. Student Park
 - 30. Student Square (Phase VIII)
 - 31. Building
 - 32. Farm Shop
 - 33. E.B. Evans Animal Industries Building
 - 34. Electrical Engineering Building
 - 35. Gilbert Engineering Building
 - 36. C.L. Wilson Engineering Building
 - 37. S.P. Collins Engineering Technology Building
 - 38. Transportation Center
 - 39. Henrietta Farrell Hall
 - 40. Waste Water Plant
 - 41. Central Receiving Building/University Police Department
 - 42. Physical Plant Administration Building
 - 43. Physical Plant Administration Building
 - 44. Physical Plant Administration Building
 - 45. Physical Plant Administration Building
 - 46. G.R. Woodfolk Social & Political Science Building
 - 47. Hilliard Hall Communication Building
 - 48. Agriculture and Business Multipurpose Building
 - 49. College of Agriculture and Human Sciences
 - 50. College of Business
 - 51. College of Business
 - 52. Track and Field Complex
 - 53. Panther Stadium (Blackshear Football Field)
 - 54. Panther Stadium (Blackshear Football Field)
 - 55. Panther Stadium (Blackshear Football Field)
 - 56. Athletic Field House
 - 57. Tennis Courts
 - 58. Soccer Field
 - 59. Lady Panthers Softball Field
 - 60. Practice Field
 - 61. John W. Tankersley Baseball Field
 - 62. Don K. Clark Juvenile Justice & Psychology Building
 - 63. College of Juvenile Justice and Psychology
 - 64. Wilhelmina F. Debo Building
 - 65. Owers-Franklin Health Clinic
 - 66. Leora G. Moore Jr. Gym (I & II)
 - 67. Holland and Gaines Memorial Student Park
 - 68. L.C. Anderson Hall
 - 69. A.L. Evans Hall
 - 70. Jesse M. Drew Memorial Complex
 - 71. Willie A. Templeton Sr. Memorial Student Center (MSC)
 - 72. Student Recreation Center
 - 73. Army & Navy ROTC
 - 74. Department of Music & Drama
 - 75. Welcome Center
 - 76. Sports Complex
 - 77. Track and Field Complex
 - 78. Panther Stadium (Blackshear Football Field)
 - 79. Panther Stadium (Blackshear Football Field)
 - 80. Athletic Field House
 - 81. Tennis Courts
 - 82. Soccer Field
 - 83. Lady Panthers Softball Field
 - 84. Practice Field
 - 85. John W. Tankersley Baseball Field
- PHASE 1: 2018-2022 (1-5 YR):**
- F1 - POLICE STATION (30,000 gsf)
 - F2 - MEAT PROCESSING FACILITY (30,000 gsf)
 - F3 - ROTC BUILDING (10,000 gsf)
 - F4 - ROTC BUILDING (10,000 gsf)
 - F5 - CULTURAL ARTS CENTER (21,000 gsf)
 - F6 - HOUSING 2 (from 2011 MP) (110,000 gsf)
 - F7 - FUTURE ACADEMIC BUILDING (105,080 gsf)
 - F8 - FUTURE STUD. ACTIVITIES BUILDING (18,860 gsf)
 - F9 - FUTURE SUPPORT BUILDING (21,450 gsf)
 - F10 - FUTURE OFFICE (4,480 gsf)
 - F11 - FUTURE RETAIL OFFICE BUILDING (3,450 gsf)
 - F12 - FUTURE HOUSING BUILDING (137,560 gsf)
- PHASE 2: 2023-2027 (6-10 YR):**
- F13 - FUTURE ACADEMIC BUILDING (105,080 gsf)
 - F14 - FUTURE ACADEMIC BUILDING (105,080 gsf)
 - F15 - FUTURE LAB BUILDING (32,320 gsf)
 - F16 - FUTURE SUPPORT BUILDING (21,450 gsf)
 - F17 - FUTURE OFFICE (4,480 gsf)
 - F18 - FUTURE STUD. ACTIVITIES BUILDING (18,860 gsf)
 - F19 - FUTURE HOUSING BUILDING (137,560 gsf)
 - F20 - FUTURE HOUSING BUILDING (137,560 gsf)
 - F21 - FUTURE ACADEMIC BUILDING (105,080 gsf)
 - F22 - FUTURE LAB BUILDING (32,320 gsf)
 - F23 - FUTURE SUPPORT BUILDING (21,450 gsf)
 - F24 - FUTURE OFFICE (4,480 gsf)
 - F25 - FUTURE STUD. ACTIVITIES BUILDING (18,860 gsf)
 - F26 - FUTURE RETAIL OFFICE BUILDING (3,450 gsf)
 - F27 - FUTURE HOUSING BUILDING (137,560 gsf)
- UTILITY CORRIDORS:**
- HHW UTILITY CORRIDOR
 - CHW UTILITY CORRIDOR
 - HHW & CHW UTILITY CORRIDOR
 - 14" HHW
 - 24" CHW
 - 14" HHW / 24" CHW
 - SANITARY SEWER ONLY

1 2 3 4 5 6 7 8 9 10 11 12 13 14



SITE LOCATION
 PRAIRIE VIEW A&M UNIVERSITY
 100 ENERGY WAY SUITE 1000
 FORT WORTH, TEXAS 76102
 PRAIRIE VIEW, TX 77446



BURNS & MCDONNELL
 100 ENERGY WAY SUITE 1000
 FORT WORTH, TEXAS 76102
 (817) 437-4361

PRAIRIE VIEW A&M UNIVERSITY



DATE	10/20/2017	PKY	PKY
DESIGNED	PKY	CHECKED	ATF
2017 UTILITY MASTER PLAN MAIN CAMPUS BUILDING GROWTH OPTION 3 PHASE 1 FUTURE BUILDOUT Project 98470 Drawing 98470			
SK11 - 0 APPROXIMATE BOUNDARY		rev. 0	

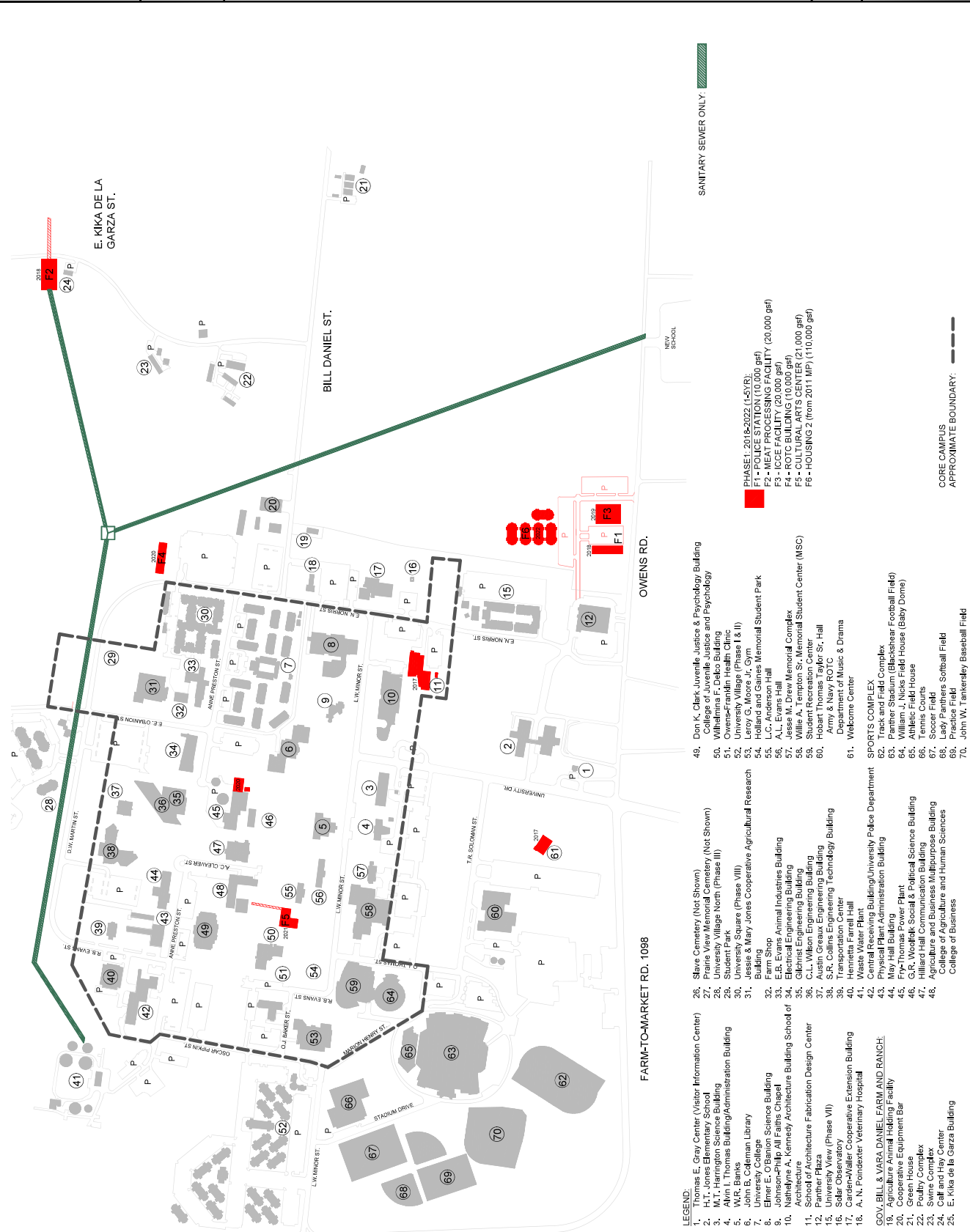

- LEGEND:**
- 1. Thomas E. Gray Center (Visitor Information Center)
 - 2. H.T. Jones Elementary School
 - 3. M.T. Harrington Science Building
 - 4. W.P. Thomas Building/Administration Building
 - 5. Student Center
 - 6. John B. Coleman Library
 - 7. University College
 - 8. Elmer E. O'Bannon Science Building
 - 9. Johnson-Phillip All Faiths Chapel
 - 10. Nathefayne A. Kennedy Architecture Building School of Architecture
 - 11. Architecture Fabrication Design Center
 - 12. Student Center Plaza
 - 13. University View (Phase VII)
 - 14. Carden-Waller Veterinary Hospital
 - 15. A. N. Poinddexter Veterinary Hospital
 - 16. A. N. Poinddexter Veterinary Hospital
 - 17. A. N. Poinddexter Veterinary Hospital
 - 18. A. N. Poinddexter Veterinary Hospital
 - 19. A. N. Poinddexter Veterinary Hospital
 - 20. A. N. Poinddexter Veterinary Hospital
 - 21. A. N. Poinddexter Veterinary Hospital
 - 22. A. N. Poinddexter Veterinary Hospital
 - 23. A. N. Poinddexter Veterinary Hospital
 - 24. A. N. Poinddexter Veterinary Hospital
 - 25. A. N. Poinddexter Veterinary Hospital
 - 26. Slave Cemetery (Not Shown)
 - 27. Prairie View Memorial Cemetery (Not Shown)
 - 28. University Village North (Phase III)
 - 29. Student Park
 - 30. University Village South (Phase I & II)
 - 31. Jesse & Mary Jones Cooperative Agricultural Research Building
 - 32. Farm Shop
 - 33. E.B. Evans Animal Industries Building
 - 34. Electrical Engineering Building
 - 35. Chemical Engineering Building
 - 36. C.L. Wilson Engineering Building
 - 37. S.G. Collins Engineering Technology Building
 - 38. Transportation Center
 - 39. Henrietta Farrell Hall
 - 40. Waste Water Plant
 - 41. Central Receiving Building/University Police Department
 - 42. Physical Plant Administration Building
 - 43. Physical Plant Administration Building
 - 44. Physical Plant Administration Building
 - 45. Physical Plant Administration Building
 - 46. G.R. Woodfolk Social & Political Science Building
 - 47. Hilliard Hall Communication Building
 - 48. Agriculture and Business Multipurpose Building
 - 49. College of Agriculture and Human Sciences
 - 50. College of Agriculture and Human Sciences
 - 51. College of Agriculture and Human Sciences
 - 52. College of Agriculture and Human Sciences
 - 53. College of Agriculture and Human Sciences
 - 54. College of Agriculture and Human Sciences
 - 55. College of Agriculture and Human Sciences
 - 56. College of Agriculture and Human Sciences
 - 57. College of Agriculture and Human Sciences
 - 58. College of Agriculture and Human Sciences
 - 59. College of Agriculture and Human Sciences
 - 60. College of Agriculture and Human Sciences
 - 61. College of Agriculture and Human Sciences
 - 62. Track and Field Complex
 - 63. Panther Stadium (Blackshear Football Field)
 - 64. Youth Center and House (Baby Dome)
 - 65. Athletic Field House
 - 66. Tennis Courts
 - 67. Soccer Field
 - 68. Lady Panthers Softball Field
 - 69. Practice Field
 - 70. John W. Tankersley Baseball Field
- PHASE I, 2018 & 2022 (4.5YR):**
- F1 - POLICE STATION (10,000 gsf)
 - F2 - MEAT PROCESSING FACILITY (20,000 gsf)
 - F3 - ICCE BUILDING (10,000 gsf)
 - F4 - ROTC BUILDING (10,000 gsf)
 - F5 - CULTURAL ARTS CENTER (21,000 gsf)
 - F6 - HOUSING 2 (from 2011 MP) (110,000 gsf)
- PHASE II, 2023 & 2027 (4.5YR):**
- F7 - POLICE STATION (10,000 gsf)
 - F8 - MEAT PROCESSING FACILITY (20,000 gsf)
 - F9 - ICCE BUILDING (10,000 gsf)
 - F10 - ROTC BUILDING (10,000 gsf)
 - F11 - CULTURAL ARTS CENTER (21,000 gsf)
 - F12 - HOUSING 2 (from 2011 MP) (110,000 gsf)
- PHASE III, 2028 & 2032 (4.5YR):**
- F13 - POLICE STATION (10,000 gsf)
 - F14 - MEAT PROCESSING FACILITY (20,000 gsf)
 - F15 - ICCE BUILDING (10,000 gsf)
 - F16 - ROTC BUILDING (10,000 gsf)
 - F17 - CULTURAL ARTS CENTER (21,000 gsf)
 - F18 - HOUSING 2 (from 2011 MP) (110,000 gsf)
- PHASE IV, 2033 & 2037 (4.5YR):**
- F19 - POLICE STATION (10,000 gsf)
 - F20 - MEAT PROCESSING FACILITY (20,000 gsf)
 - F21 - ICCE BUILDING (10,000 gsf)
 - F22 - ROTC BUILDING (10,000 gsf)
 - F23 - CULTURAL ARTS CENTER (21,000 gsf)
 - F24 - HOUSING 2 (from 2011 MP) (110,000 gsf)
- PHASE V, 2038 & 2042 (4.5YR):**
- F25 - POLICE STATION (10,000 gsf)
 - F26 - MEAT PROCESSING FACILITY (20,000 gsf)
 - F27 - ICCE BUILDING (10,000 gsf)
 - F28 - ROTC BUILDING (10,000 gsf)
 - F29 - CULTURAL ARTS CENTER (21,000 gsf)
 - F30 - HOUSING 2 (from 2011 MP) (110,000 gsf)
- PHASE VI, 2043 & 2047 (4.5YR):**
- F31 - POLICE STATION (10,000 gsf)
 - F32 - MEAT PROCESSING FACILITY (20,000 gsf)
 - F33 - ICCE BUILDING (10,000 gsf)
 - F34 - ROTC BUILDING (10,000 gsf)
 - F35 - CULTURAL ARTS CENTER (21,000 gsf)
 - F36 - HOUSING 2 (from 2011 MP) (110,000 gsf)
- PHASE VII, 2048 & 2052 (4.5YR):**
- F37 - POLICE STATION (10,000 gsf)
 - F38 - MEAT PROCESSING FACILITY (20,000 gsf)
 - F39 - ICCE BUILDING (10,000 gsf)
 - F40 - ROTC BUILDING (10,000 gsf)
 - F41 - CULTURAL ARTS CENTER (21,000 gsf)
 - F42 - HOUSING 2 (from 2011 MP) (110,000 gsf)
- PHASE VIII, 2053 & 2057 (4.5YR):**
- F43 - POLICE STATION (10,000 gsf)
 - F44 - MEAT PROCESSING FACILITY (20,000 gsf)
 - F45 - ICCE BUILDING (10,000 gsf)
 - F46 - ROTC BUILDING (10,000 gsf)
 - F47 - CULTURAL ARTS CENTER (21,000 gsf)
 - F48 - HOUSING 2 (from 2011 MP) (110,000 gsf)
- PHASE IX, 2058 & 2062 (4.5YR):**
- F49 - POLICE STATION (10,000 gsf)
 - F50 - MEAT PROCESSING FACILITY (20,000 gsf)
 - F51 - ICCE BUILDING (10,000 gsf)
 - F52 - ROTC BUILDING (10,000 gsf)
 - F53 - CULTURAL ARTS CENTER (21,000 gsf)
 - F54 - HOUSING 2 (from 2011 MP) (110,000 gsf)
- PHASE X, 2063 & 2067 (4.5YR):**
- F55 - POLICE STATION (10,000 gsf)
 - F56 - MEAT PROCESSING FACILITY (20,000 gsf)
 - F57 - ICCE BUILDING (10,000 gsf)
 - F58 - ROTC BUILDING (10,000 gsf)
 - F59 - CULTURAL ARTS CENTER (21,000 gsf)
 - F60 - HOUSING 2 (from 2011 MP) (110,000 gsf)
- PHASE XI, 2068 & 2072 (4.5YR):**
- F61 - POLICE STATION (10,000 gsf)
 - F62 - MEAT PROCESSING FACILITY (20,000 gsf)
 - F63 - ICCE BUILDING (10,000 gsf)
 - F64 - ROTC BUILDING (10,000 gsf)
 - F65 - CULTURAL ARTS CENTER (21,000 gsf)
 - F66 - HOUSING 2 (from 2011 MP) (110,000 gsf)
- PHASE XII, 2073 & 2077 (4.5YR):**
- F67 - POLICE STATION (10,000 gsf)
 - F68 - MEAT PROCESSING FACILITY (20,000 gsf)
 - F69 - ICCE BUILDING (10,000 gsf)
 - F70 - ROTC BUILDING (10,000 gsf)
 - F71 - CULTURAL ARTS CENTER (21,000 gsf)
 - F72 - HOUSING 2 (from 2011 MP) (110,000 gsf)
- PHASE XIII, 2078 & 2082 (4.5YR):**
- F73 - POLICE STATION (10,000 gsf)
 - F74 - MEAT PROCESSING FACILITY (20,000 gsf)
 - F75 - ICCE BUILDING (10,000 gsf)
 - F76 - ROTC BUILDING (10,000 gsf)
 - F77 - CULTURAL ARTS CENTER (21,000 gsf)
 - F78 - HOUSING 2 (from 2011 MP) (110,000 gsf)
- PHASE XIV, 2083 & 2087 (4.5YR):**
- F79 - POLICE STATION (10,000 gsf)
 - F80 - MEAT PROCESSING FACILITY (20,000 gsf)
 - F81 - ICCE BUILDING (10,000 gsf)
 - F82 - ROTC BUILDING (10,000 gsf)
 - F83 - CULTURAL ARTS CENTER (21,000 gsf)
 - F84 - HOUSING 2 (from 2011 MP) (110,000 gsf)
- PHASE XV, 2088 & 2092 (4.5YR):**
- F85 - POLICE STATION (10,000 gsf)
 - F86 - MEAT PROCESSING FACILITY (20,000 gsf)
 - F87 - ICCE BUILDING (10,000 gsf)
 - F88 - ROTC BUILDING (10,000 gsf)
 - F89 - CULTURAL ARTS CENTER (21,000 gsf)
 - F90 - HOUSING 2 (from 2011 MP) (110,000 gsf)
- PHASE XVI, 2093 & 2097 (4.5YR):**
- F89 - POLICE STATION (10,000 gsf)
 - F90 - MEAT PROCESSING FACILITY (20,000 gsf)
 - F91 - ICCE BUILDING (10,000 gsf)
 - F92 - ROTC BUILDING (10,000 gsf)
 - F93 - CULTURAL ARTS CENTER (21,000 gsf)
 - F94 - HOUSING 2 (from 2011 MP) (110,000 gsf)
- PHASE XVII, 2098 & 2102 (4.5YR):**
- F95 - POLICE STATION (10,000 gsf)
 - F96 - MEAT PROCESSING FACILITY (20,000 gsf)
 - F97 - ICCE BUILDING (10,000 gsf)
 - F98 - ROTC BUILDING (10,000 gsf)
 - F99 - CULTURAL ARTS CENTER (21,000 gsf)
 - F100 - HOUSING 2 (from 2011 MP) (110,000 gsf)
- PHASE XVIII, 2103 & 2107 (4.5YR):**
- F99 - POLICE STATION (10,000 gsf)
 - F100 - MEAT PROCESSING FACILITY (20,000 gsf)
 - F101 - ICCE BUILDING (10,000 gsf)
 - F102 - ROTC BUILDING (10,000 gsf)
 - F103 - CULTURAL ARTS CENTER (21,000 gsf)
 - F104 - HOUSING 2 (from 2011 MP) (110,000 gsf)
- PHASE XIX, 2108 & 2112 (4.5YR):**
- F103 - POLICE STATION (10,000 gsf)
 - F104 - MEAT PROCESSING FACILITY (20,000 gsf)
 - F105 - ICCE BUILDING (10,000 gsf)
 - F106 - ROTC BUILDING (10,000 gsf)
 - F107 - CULTURAL ARTS CENTER (21,000 gsf)
 - F108 - HOUSING 2 (from 2011 MP) (110,000 gsf)
- PHASE XX, 2113 & 2117 (4.5YR):**
- F107 - POLICE STATION (10,000 gsf)
 - F108 - MEAT PROCESSING FACILITY (20,000 gsf)
 - F109 - ICCE BUILDING (10,000 gsf)
 - F110 - ROTC BUILDING (10,000 gsf)
 - F111 - CULTURAL ARTS CENTER (21,000 gsf)
 - F112 - HOUSING 2 (from 2011 MP) (110,000 gsf)
- PHASE XXI, 2118 & 2122 (4.5YR):**
- F111 - POLICE STATION (10,000 gsf)
 - F112 - MEAT PROCESSING FACILITY (20,000 gsf)
 - F113 - ICCE BUILDING (10,000 gsf)
 - F114 - ROTC BUILDING (10,000 gsf)
 - F115 - CULTURAL ARTS CENTER (21,000 gsf)
 - F116 - HOUSING 2 (from 2011 MP) (110,000 gsf)
- PHASE XXII, 2123 & 2127 (4.5YR):**
- F115 - POLICE STATION (10,000 gsf)
 - F116 - MEAT PROCESSING FACILITY (20,000 gsf)
 - F117 - ICCE BUILDING (10,000 gsf)
 - F118 - ROTC BUILDING (10,000 gsf)
 - F119 - CULTURAL ARTS CENTER (21,000 gsf)
 - F120 - HOUSING 2 (from 2011 MP) (110,000 gsf)
- PHASE XXIII, 2128 & 2132 (4.5YR):**
- F119 - POLICE STATION (10,000 gsf)
 - F120 - MEAT PROCESSING FACILITY (20,000 gsf)
 - F121 - ICCE BUILDING (10,000 gsf)
 - F122 - ROTC BUILDING (10,000 gsf)
 - F123 - CULTURAL ARTS CENTER (21,000 gsf)
 - F124 - HOUSING 2 (from 2011 MP) (110,000 gsf)
- PHASE XXIV, 2133 & 2137 (4.5YR):**
- F123 - POLICE STATION (10,000 gsf)
 - F124 - MEAT PROCESSING FACILITY (20,000 gsf)
 - F125 - ICCE BUILDING (10,000 gsf)
 - F126 - ROTC BUILDING (10,000 gsf)
 - F127 - CULTURAL ARTS CENTER (21,000 gsf)
 - F128 - HOUSING 2 (from 2011 MP) (110,000 gsf)
- PHASE XXV, 2138 & 2142 (4.5YR):**
- F127 - POLICE STATION (10,000 gsf)
 - F128 - MEAT PROCESSING FACILITY (20,000 gsf)
 - F129 - ICCE BUILDING (10,000 gsf)
 - F130 - ROTC BUILDING (10,000 gsf)
 - F131 - CULTURAL ARTS CENTER (21,000 gsf)
 - F132 - HOUSING 2 (from 2011 MP) (110,000 gsf)
- PHASE XXVI, 2143 & 2147 (4.5YR):**
- F131 - POLICE STATION (10,000 gsf)
 - F132 - MEAT PROCESSING FACILITY (20,000 gsf)
 - F133 - ICCE BUILDING (10,000 gsf)
 - F134 - ROTC BUILDING (10,000 gsf)
 - F135 - CULTURAL ARTS CENTER (21,000 gsf)
 - F136 - HOUSING 2 (from 2011 MP) (110,000 gsf)
- PHASE XXVII, 2148 & 2152 (4.5YR):**
- F135 - POLICE STATION (10,000 gsf)
 - F136 - MEAT PROCESSING FACILITY (20,000 gsf)
 - F137 - ICCE BUILDING (10,000 gsf)
 - F138 - ROTC BUILDING (10,000 gsf)
 - F139 - CULTURAL ARTS CENTER (21,000 gsf)
 - F140 - HOUSING 2 (from 2011 MP) (110,000 gsf)
- PHASE XXVIII, 2153 & 2157 (4.5YR):**
- F139 - POLICE STATION (10,000 gsf)
 - F140 - MEAT PROCESSING FACILITY (20,000 gsf)
 - F141 - ICCE BUILDING (10,000 gsf)
 - F142 - ROTC BUILDING (10,000 gsf)
 - F143 - CULTURAL ARTS CENTER (21,000 gsf)
 - F144 - HOUSING 2 (from 2011 MP) (110,000 gsf)
- PHASE XXIX, 2158 & 2162 (4.5YR):**
- F143 - POLICE STATION (10,000 gsf)
 - F144 - MEAT PROCESSING FACILITY (20,000 gsf)
 - F145 - ICCE BUILDING (10,000 gsf)
 - F146 - ROTC BUILDING (10,000 gsf)
 - F147 - CULTURAL ARTS CENTER (21,000 gsf)
 - F148 - HOUSING 2 (from 2011 MP) (110,000 gsf)
- PHASE XXX, 2163 & 2167 (4.5YR):**
- F147 - POLICE STATION (10,000 gsf)
 - F148 - MEAT PROCESSING FACILITY (20,000 gsf)
 - F149 - ICCE BUILDING (10,000 gsf)
 - F150 - ROTC BUILDING (10,000 gsf)
 - F151 - CULTURAL ARTS CENTER (21,000 gsf)
 - F152 - HOUSING 2 (from 2011 MP) (110,000 gsf)
- PHASE XXXI, 2168 & 2172 (4.5YR):**
- F151 - POLICE STATION (10,000 gsf)
 - F152 - MEAT PROCESSING FACILITY (20,000 gsf)
 - F153 - ICCE BUILDING (10,000 gsf)
 - F154 - ROTC BUILDING (10,000 gsf)
 - F155 - CULTURAL ARTS CENTER (21,000 gsf)
 - F156 - HOUSING 2 (from 2011 MP) (110,000 gsf)
- PHASE XXXII, 2173 & 2177 (4.5YR):**
- F155 - POLICE STATION (10,000 gsf)
 - F156 - MEAT PROCESSING FACILITY (20,000 gsf)
 - F157 - ICCE BUILDING (10,000 gsf)
 - F158 - ROTC BUILDING (10,000 gsf)
 - F159 - CULTURAL ARTS CENTER (21,000 gsf)
 - F160 - HOUSING 2 (from 2011 MP) (110,000 gsf)
- PHASE XXXIII, 2178 & 2182 (4.5YR):**
- F159 - POLICE STATION (10,000 gsf)
 - F160 - MEAT PROCESSING FACILITY (20,000 gsf)
 - F161 - ICCE BUILDING (10,000 gsf)
 - F162 - ROTC BUILDING (10,000 gsf)
 - F163 - CULTURAL ARTS CENTER (21,000 gsf)
 - F164 - HOUSING 2 (from 2011 MP) (110,000 gsf)
- PHASE XXXIV, 2183 & 2187 (4.5YR):**
- F163 - POLICE STATION (10,000 gsf)
 - F164 - MEAT PROCESSING FACILITY (20,000 gsf)
 - F165 - ICCE BUILDING (10,000 gsf)
 - F166 - ROTC BUILDING (10,000 gsf)
 - F167 - CULTURAL ARTS CENTER (21,000 gsf)
 - F168 - HOUSING 2 (from 2011 MP) (110,000 gsf)
- PHASE XXXV, 2188 & 2192 (4.5YR):**
- F167 - POLICE STATION (10,000 gsf)
 - F168 - MEAT PROCESSING FACILITY (20,000 gsf)
 - F169 - ICCE BUILDING (10,000 gsf)
 - F170 - ROTC BUILDING (10,000 gsf)
 - F171 - CULTURAL ARTS CENTER (21,000 gsf)
 - F172 - HOUSING 2 (from 2011 MP) (110,000 gsf)
- PHASE XXXVI, 2193 & 2197 (4.5YR):**
- F171 - POLICE STATION (10,000 gsf)
 - F172 - MEAT PROCESSING FACILITY (20,000 gsf)
 - F173 - ICCE BUILDING (10,000 gsf)
 - F174 - ROTC BUILDING (10,000 gsf)
 - F175 - CULTURAL ARTS CENTER (21,000 gsf)
 - F176 - HOUSING 2 (from 2011 MP) (110,000 gsf)
- PHASE XXXVII, 2198 & 2202 (4.5YR):**
- F175 - POLICE STATION (10,000 gsf)
 - F176 - MEAT PROCESSING FACILITY (20,000 gsf)
 - F177 - ICCE BUILDING (10,000 gsf)
 - F178 - ROTC BUILDING (10,000 gsf)
 - F179 - CULTURAL ARTS CENTER (21,000 gsf)
 - F180 - HOUSING 2 (from 2011 MP) (110,000 gsf)
- PHASE XXXVIII, 2203 & 2207 (4.5YR):**
- F179 - POLICE STATION (10,000 gsf)
 - F180 - MEAT PROCESSING FACILITY (20,000 gsf)
 - F181 - ICCE BUILDING (10,000 gsf)
 - F182 - ROTC BUILDING (10,000 gsf)
 - F183 - CULTURAL ARTS CENTER (21,000 gsf)
 - F184 - HOUSING 2 (from 2011 MP) (110,000 gsf)
- PHASE XXXIX, 2208 & 2212 (4.5YR):**
- F183 - POLICE STATION (10,000 gsf)
 - F184 - MEAT PROCESSING FACILITY (20,000 gsf)
 - F185 - ICCE BUILDING (10,000 gsf)
 - F186 - ROTC BUILDING (10,000 gsf)
 - F187 - CULTURAL ARTS CENTER (21,000 gsf)
 - F188 - HOUSING 2 (from 2011 MP) (110,000 gsf)
- PHASE XL, 2213 & 2217 (4.5YR):**
- F187 - POLICE STATION (10,000 gsf)
 - F188 - MEAT PROCESSING FACILITY (20,000 gsf)
 - F189 - ICCE BUILDING (10,000 gsf)
 - F190 - ROTC BUILDING (10,000 gsf)
 - F191 - CULTURAL ARTS CENTER (21,000 gsf)
 - F192 - HOUSING 2 (from 2011 MP) (110,000 gsf)
- PHASE XLI, 2218 & 2222 (4.5YR):**
- F191 - POLICE STATION (10,000 gsf)
 - F192 - MEAT PROCESSING FACILITY (20,000 gsf)
 - F193 - ICCE BUILDING (10,000 gsf)
 - F194 - ROTC BUILDING (10,000 gsf)
 - F195 - CULTURAL ARTS CENTER (21,000 gsf)
 - F196 - HOUSING 2 (from 2011 MP) (110,000 gsf)
- PHASE XLII, 2223 & 2227 (4.5YR):**
- F195 - POLICE STATION (10,000 gsf)
 - F196 - MEAT PROCESSING FACILITY (20,000 gsf)
 - F197 - ICCE BUILDING (10,000 gsf)
 - F198 - ROTC BUILDING (10,000 gsf)
 - F199 - CULTURAL ARTS CENTER (21,000 gsf)
 - F200 - HOUSING 2 (from 2011 MP) (110,000 gsf)
- PHASE XLIII, 2228 & 2232 (4.5YR):**
- F199 - POLICE STATION (10,000 gsf)
 - F200 - MEAT PROCESSING FACILITY (20,000 gsf)
 - F201 - ICCE BUILDING (10,000 gsf)
 - F202 - ROTC BUILDING (10,000 gsf)
 - F203 - CULTURAL ARTS CENTER (21,000 gsf)
 - F204 - HOUSING 2 (from 2011 MP) (110,000 gsf)
- PHASE XLIV, 2233 & 2237 (4.5YR):**
- F203 - POLICE STATION (10,000 gsf)
 - F204 - MEAT PROCESSING FACILITY (20,000 gsf)
 - F205 - ICCE BUILDING (10,000 gsf)
 - F206 - ROTC BUILDING (10,000 gsf)
 - F207 - CULTURAL ARTS CENTER (21,000 gsf)
 - F208 - HOUSING 2 (from 2011 MP) (110,000 gsf)
- PHASE XLV, 2238 & 2242 (4.5YR):**
- F207 - POLICE STATION (10,000 gsf)
 - F208 - MEAT PROCESSING FACILITY (20,000 gsf)
 - F209 - ICCE BUILDING (10,000 gsf)
 - F210 - ROTC BUILDING (10,000 gsf)
 - F211 - CULTURAL ARTS CENTER (21,000 gsf)
 - F212 - HOUSING 2 (from 2011 MP) (110,000 gsf)
- PHASE XLVI, 2243 & 2247 (4.5YR):**
- F211 - POLICE STATION (10,000 gsf)
 - F212 - MEAT PROCESSING FACILITY (20,000 gsf)
 - F213 - ICCE BUILDING (10,000 gsf)
 - F214 - ROTC BUILDING (10,000 gsf)
 - F215 - CULTURAL ARTS CENTER (21,000 gsf)
 - F216 - HOUSING 2 (from 2011 MP) (110,000 gsf)
- PHASE XLVII, 2248 & 2252 (4.5YR):**
- F215 - POLICE STATION (10,000 gsf)
 - F216 - MEAT PROCESSING FACILITY (20,000 gsf)
 - F217 - ICCE BUILDING (10,000 gsf)
 - F218 - ROTC BUILDING (10,000 gsf)
 - F219 - CULTURAL ARTS CENTER (21,000 gsf)
 - F220 - HOUSING 2 (from 2011 MP) (110,000 gsf)
- PHASE XLVIII, 2253 & 2257 (4.5YR):**
- F219 - POLICE STATION (10,000 gsf)
 - F220 - MEAT PROCESSING FACILITY (20,000 gsf)
 - F221 - ICCE BUILDING (10,000 gsf)
 - F222 - ROTC BUILDING (10,000 gsf)
 - F223 - CULTURAL ARTS CENTER (21,000 gsf)
 - F224 - HOUSING 2 (from 2011 MP) (110,000 gsf)
- PHASE XLIX, 2258 & 2262 (4.5YR):**
- F223 - POLICE STATION (10,000 gsf)
 - F224 - MEAT PROCESSING FACILITY (20,000 gsf)
 - F225 - ICCE BUILDING (10,000 gsf)
 - F226 - ROTC BUILDING (10,000 gsf)
 - F227 - CULTURAL ARTS CENTER (21,000 gsf)
 - F228 - HOUSING 2 (from 2011 MP) (110,000 gsf)
- PHASE L, 2263 & 2267 (4.5YR):**
- F227 - POLICE STATION (10,000 gsf)
 - F228 - MEAT PROCESSING FACILITY (20,000 gsf)
 - F229 - ICCE BUILDING (10,000 gsf)
 - F230 - ROTC BUILDING (10,000 gsf)
 - F231 - CULTURAL ARTS CENTER (21,000 gsf)
 - F232 - HOUSING 2 (from 2011 MP) (110,000 gsf)
- PHASE LI, 2268 & 2272 (4.5YR):**
- F231 - POLICE STATION (10,000 gsf)
 - F232 - MEAT PROCESSING FACILITY (20,000 gsf)
 - F233 - ICCE BUILDING (10,000 gsf)
 - F234 - ROTC BUILDING (10,000 gsf)
 - F235 - CULTURAL ARTS CENTER (21,000 gsf)
 - F236 - HOUSING 2 (from 2011 MP) (110,000 gsf)
- PHASE LII, 2273 & 2277 (4.5YR):**
- F235 - POLICE STATION (10,000 gsf)
 - F236 - MEAT PROCESSING FACILITY (20,000 gsf)
 - F237 - ICCE BUILDING (10,000 gsf)
 - F238 - ROTC BUILDING (10,000 gsf)
 - F239 - CULTURAL ARTS CENTER (21,000 gsf)
 - F240 - HOUSING 2 (from 2011 MP) (110,000 gsf)
- PHASE LIII, 2278 & 2282 (4.5YR):**
- F239 - POLICE STATION (10,000 gsf)
 - F240 - MEAT PROCESSING FACILITY (20,000 gsf)
 - F

1 2 3 4 5 6 7 8 9 10 11 12 13 14

SITE LOCATION
 PRAIRIE VIEW A&M UNIVERSITY
 100 ENERGY WAY SUITE 1000
 FARM TO MARKET RD.
 PRAIRIE VIEW, TX 77446

BURNS & MCDONNELL
 100 ENERGY WAY SUITE 1000
 FARM TO MARKET RD.
 PRAIRIE VIEW, TX 77446
 817.437.4381

PRAIRIE VIEW A&M UNIVERSITY

DATE	10/20/2017	PKY	PKY
DESIGNED	PKY	CHECKED	ATF
2017 UTILITY MASTER PLAN MAIN CAMPUS BUILDINGS-GROWTH OPTION 3 PHASE 3 FUTURE BUILDOUT			
PROJECT	98470	REV.	
DRAWING			
			SK13 - 0

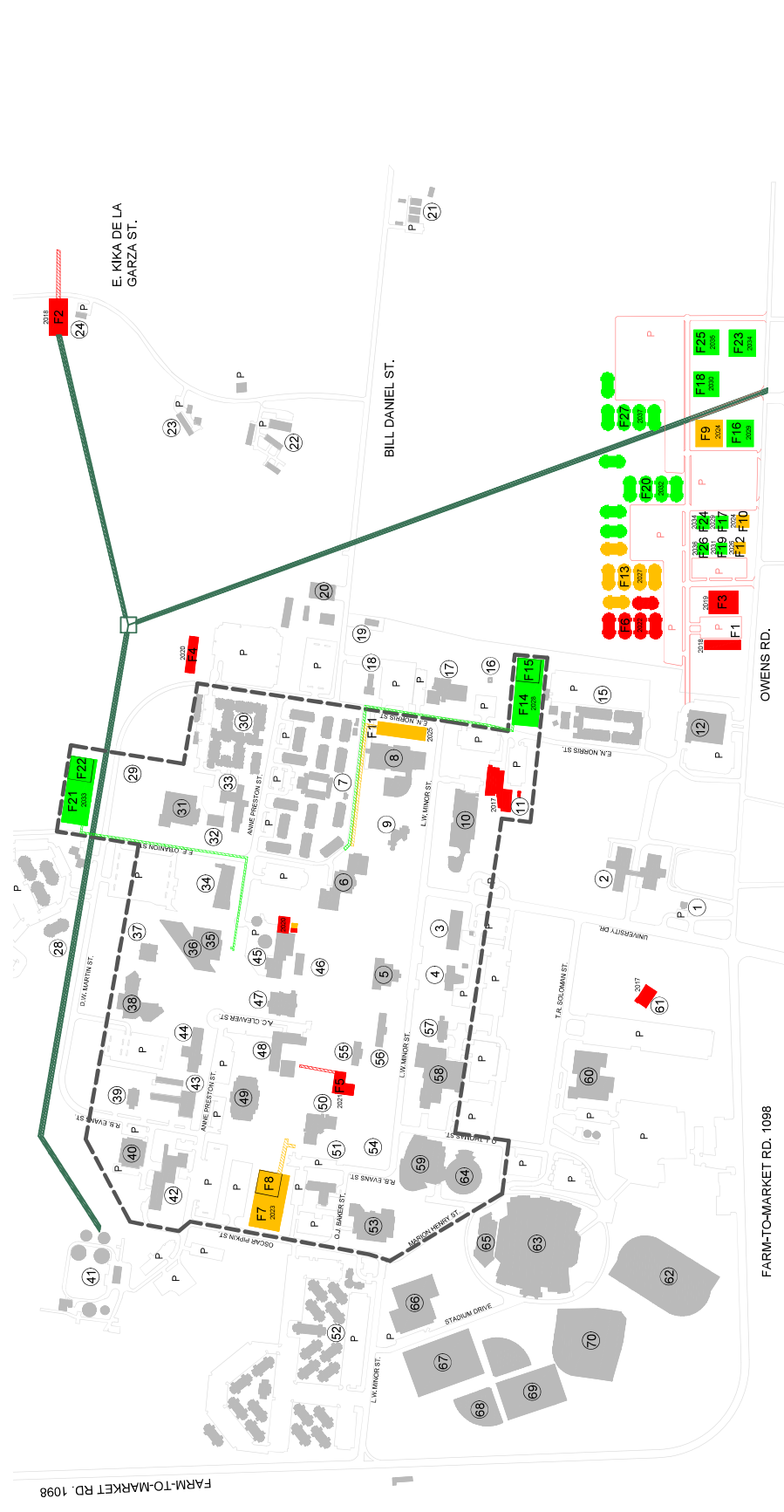

- LEGEND:**
- 1. Thomas E. Gray Center (Visitor Information Center)
 - 2. H.T. Jones Elementary School
 - 3. M.T. Harrington Science Building
 - 4. W.P. Thomas Building/Administration Building
 - 5. Student Plaza
 - 6. John B. Coleman Library
 - 7. University College
 - 8. Elmer E. O'Bannon Science Building
 - 9. Johnson-Philo All Faiths Chapel
 - 10. Nathefayne A. Kennedy Architecture Building School of Architecture
 - 11. Architecture
 - 12. Architecture Fabrication Design Center
 - 13. Student Plaza
 - 14. University View (Phase VII)
 - 15. Solar Observatory
 - 16. Carden-Walker Cooperative Veterinary Hospital
 - 17. A. N. Ponder Veterinary Hospital
 - 18. Waste Water Plant
 - 19. Central Receiving Building/University Police Department
 - 20. Physical Plant Administration Building
 - 21. Physical Plant
 - 22. G.R. Woodfolk Social & Political Science Building
 - 23. Hilliard Hall Communication Building
 - 24. Agriculture and Business Multipurpose Building
 - 25. College of Agriculture and Human Sciences
 - 26. Slave Cemetery (Not Shown)
 - 27. Prairie View Memorial Cemetery (Not Shown)
 - 28. University Village North (Phase III)
 - 29. Student Park
 - 30. University Village South (Phase I & II)
 - 31. Jesse & Mary Jones Cooperative Agricultural Research Building
 - 32. Farm Shop
 - 33. E.B. Evans Animal Industries Building
 - 34. Electrical Engineering Building
 - 35. Gilbert Engineering Building
 - 36. C.L. Wilson Engineering Building
 - 37. S.P. Collins Engineering Technology Building
 - 38. Transportation Center
 - 39. Henrietta Farrell Hall
 - 40. Waste Water Plant
 - 41. Central Receiving Building/University Police Department
 - 42. Physical Plant Administration Building
 - 43. Physical Plant
 - 44. G.R. Woodfolk Social & Political Science Building
 - 45. Hilliard Hall Communication Building
 - 46. Agriculture and Business Multipurpose Building
 - 47. College of Agriculture and Human Sciences
 - 48. College of Business
 - 49. Don K. Clark Juvenile Justice & Psychology Building
 - 50. College of Juvenile Justice and Psychology
 - 51. Wilhelmina F. Debo Building
 - 52. Owens-Franklin Health Clinic
 - 53. Leroy G. Moore Jr. Gym (I & II)
 - 54. Holland and Gaines Memorial Student Park
 - 55. L.C. Anderson Hall
 - 56. A.L. Evans Hall
 - 57. Jesse M. Drew Memorial Complex
 - 58. Willie A. Tompkins Sr. Memorial Student Center (MSC)
 - 59. Student Recreation Center
 - 60. Army & Navy ROTC
 - 61. Department of Music & Drama
 - 62. Welcome Center
 - 63. Track and Field Complex
 - 64. Panther Stadium (Blackshear Football Field)
 - 65. Yarnall Hall (Housing - Baby Dome)
 - 66. Athletic Field House
 - 67. Tennis Courts
 - 68. Soccer Field
 - 69. Lady Panthers Softball Field
 - 70. Practice Field
 - 71. John W. Tankersley Baseball Field
- PHASE 1, 2018-2022 (4-5 YR):**
- F1 - POLICE STATION (10,000 gsf)
 - F2 - MEAT PROCESSING FACILITY (20,000 gsf)
 - F3 - ROTC BUILDING (10,000 gsf)
 - F4 - ROTC BUILDING (10,000 gsf)
 - F5 - CULTURAL ARTS CENTER (21,000 gsf)
 - F6 - HOUSING 2 (from 2011 MP) (110,000 gsf)
 - F7 - FUTURE ACADEMIC BUILDING (105,080 gsf)
 - F8 - FUTURE STUD. ACTIVITIES BUILDING (18,860 gsf)
 - F9 - FUTURE OFFICE (4,480 gsf)
 - F10 - FUTURE STUD. ACTIVITIES BUILDING (18,860 gsf)
 - F11 - FUTURE OFFICE (4,480 gsf)
 - F12 - FUTURE RETAIL OFFICE BUILDING (3,450 gsf)
 - F13 - FUTURE HOUSING BUILDING (137,560 gsf)
- PHASE 2, 2023-2027 (6-7 YR):**
- F14 - FUTURE ACADEMIC BUILDING (105,080 gsf)
 - F15 - FUTURE LAB BUILDING (32,320 gsf)
 - F16 - FUTURE SUPPORT BUILDING (21,450 gsf)
 - F17 - FUTURE OFFICE (4,480 gsf)
 - F18 - FUTURE STUD. ACTIVITIES BUILDING (18,860 gsf)
 - F19 - FUTURE OFFICE (4,480 gsf)
 - F20 - FUTURE STUD. ACTIVITIES BUILDING (18,860 gsf)
 - F21 - FUTURE ACADEMIC BUILDING (105,080 gsf)
 - F22 - FUTURE LAB BUILDING (32,320 gsf)
 - F23 - FUTURE OFFICE (4,480 gsf)
 - F24 - FUTURE STUD. ACTIVITIES BUILDING (18,860 gsf)
 - F25 - FUTURE RETAIL OFFICE BUILDING (3,450 gsf)
 - F26 - FUTURE HOUSING BUILDING (137,560 gsf)
- PHASE 3, 2028-2037 (11-20 YRS):**
- F27 - FUTURE ACADEMIC BUILDING (105,080 gsf)
 - F28 - FUTURE LAB BUILDING (32,320 gsf)
 - F29 - FUTURE SUPPORT BUILDING (21,450 gsf)
 - F30 - FUTURE OFFICE (4,480 gsf)
 - F31 - FUTURE STUD. ACTIVITIES BUILDING (18,860 gsf)
 - F32 - FUTURE OFFICE (4,480 gsf)
 - F33 - FUTURE STUD. ACTIVITIES BUILDING (18,860 gsf)
 - F34 - FUTURE RETAIL OFFICE BUILDING (3,450 gsf)
 - F35 - FUTURE HOUSING BUILDING (137,560 gsf)
- UTILITY LINES:**
- SAINTANARY SEWER ONLY.
- BOUNDARIES:**
- SANITARY SEWER ONLY.
 - CORE CAMPUS
 - APPROXIMATE BOUNDARY.

1 2 3 4 5 6 7 8 9 10 11 12 13 14

SITE LOCATION
 PRAIRIE VIEW A&M UNIVERSITY
 100 ENERGY WAY SUITE 1000
 FORT WORTH, TX 76102
 817-437-4381

BURNS & MCDONNELL
 100 ENERGY WAY SUITE 1000
 FORT WORTH, TX 76102
 817-437-4381

PRAIRIE VIEW A&M UNIVERSITY

DATE	10/20/2017	PKY	checked
DESIGNED	PKY	ATF	
PROJECT	2017 UTILITY MASTER PLAN MAIN CAMPUS BUILDINGS GROWTH CAMPUS PHAS ALL UTILITIES		
DRAWING	98470	REV.	0
PROJECT	SK15 - 0		

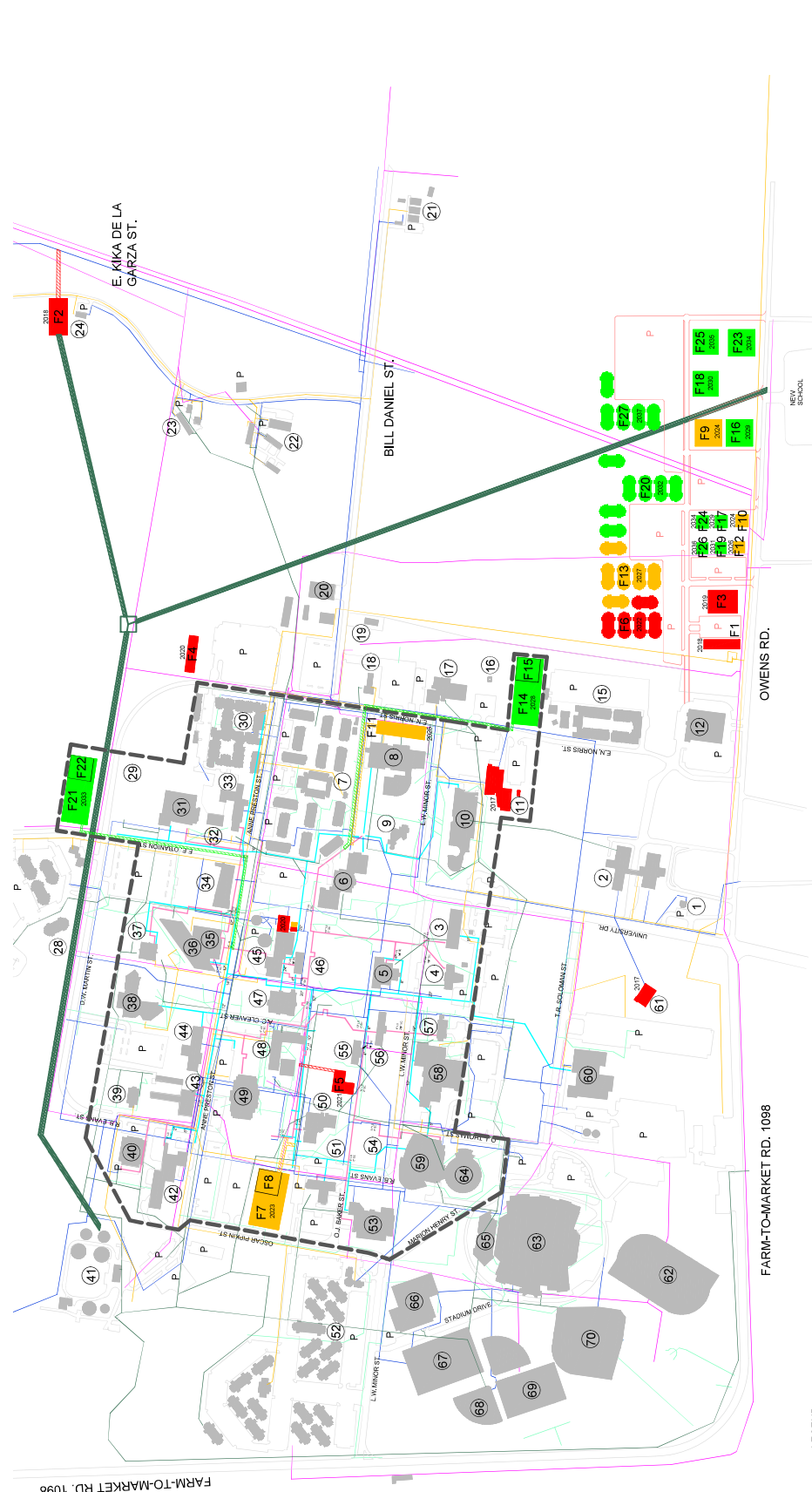

- LEGEND:**
- Thomas E. Gray Center (Visitor Information Center)
 - H.T. Jones Elementary School
 - M.T. Harrington Science Building
 - W.P. Thomas Building/Administration Building
 - John B. Coleman Library
 - Elmer E. O'Bannon Science Building
 - Johnston-Phelps All Faiths Chapel
 - Nathalyne A. Kennedy Architecture Building School of Architecture
 - Architecture Fabrication Design Center
 - Pattee Plaza
 - University View (Phase VII)
 - Carden-Walker Cooperative Veterinary Hospital
 - A. N. Ponder Veterinary Hospital
 - GOV. BILL & WARA DANIEL FARM AND RANCH
 - GOV. DANIEL DANIEL FARM
 - Cooperative Equipment Bar
 - Green House
 - Poultry Complex
 - Swine Complex
 - Calf and Hay Center
 - E. Kika de la Garza Building
 - Slave Cemetery (Not Shown)
 - Prairie View Memorial Cemetery (Not Shown)
 - Student Park
 - University Squares (Phase VIII)
 - Johnston Squares (Phase I & II)
 - Jessie & Mary Jones Cooperative Agricultural Research Building
 - Farm Shop
 - E.B. Evans Animal Industries Building
 - Electrical Engineering Building
 - Cliburn Engineering Building
 - C.L. Wilson Engineering Building
 - Engineering Technology Building
 - S.P. Collins Engineering Technology Building
 - Transportation Center
 - Hennetta Farrell Hall
 - Waste Water Plant
 - Central Receiving Building/University Police Department
 - Physical Plant Administration Building
 - Hay Hall Building
 - University Police Facility
 - Cooperative Equipment Bar
 - Green House
 - Woolfolk Social & Political Science Building
 - Hilliard Hall Communication Building
 - Agriculture and Business Multipurpose Building
 - College of Agriculture and Human Sciences
 - College of Business
 - Don K. Clark Juvenile Justice & Psychology Building
 - College of Juvenile Justice and Psychology
 - Wilhelmina F. Debo Building
 - Owens-Franklin Health Clinic
 - College of Health Sciences (Phase I & II)
 - Leroy G. Moore Jr. Gymnasium
 - Holland and Gaines Memorial Student Park
 - L.C. Anderson Hall
 - A.L. Evans Hall
 - Jesse M. Drew Memorial Complex
 - Willie A. Tompion Sr. Memorial Student Center (MSC)
 - Student Recreation Center
 - Student Center
 - Army & Navy ROTC
 - Department of Music & Drama
 - Welcome Center
 - SPORTS COMPLEX
 - Track and Field Complex
 - Yanner Stadium (Blackshear Football Field)
 - Woolfolk Field House (Bobby Dome)
 - Athletic Field House
 - Tennis Courts
 - Soccer Field
 - Soccer Field
 - Lady Panthers Softball Field
 - Practice Field
 - John W. Tankersley Baseball Field
- PHASE 1: 2018-2022 (4.5YR):**
- F1 - POLICE STATION (10,000 gsf)
 - F2 - MEAT PROCESSING FACILITY (20,000 gsf)
 - F3 - ICCE FACILITY (20,000 gsf)
 - F4 - ROTC BUILDING (10,000 gsf)
 - F5 - CULTURAL ARTS CENTER (21,000 gsf)
 - F6 - HOUSING 2 (from 2011 MP) (110,000 gsf)
- PHASE 2: 2023-2027 (6-7YR):**
- F7 - FUTURE ACADEMIC BUILDING (105,080 gsf)
 - F8 - FUTURE STUD. ACTIVITIES BUILDING (18,860 gsf)
 - F9 - FUTURE OFFICE (4,480 gsf)
 - F10 - FUTURE RETAIL OFFICE BUILDING (3,450 gsf)
 - F11 - FUTURE STUD. ACTIVITIES BUILDING (18,860 gsf)
 - F12 - FUTURE OFFICE (4,480 gsf)
 - F13 - FUTURE HOUSING BUILDING (137,560 gsf)
- PHASE 3: 2028-2037 (11-20YRS):**
- F14 - FUTURE ACADEMIC BUILDING (105,080 gsf)
 - F15 - FUTURE LAB BUILDING (32,320 gsf)
 - F16 - FUTURE SUPPORT BUILDING (21,450 gsf)
 - F17 - FUTURE OFFICE (4,480 gsf)
 - F18 - FUTURE STUD. ACTIVITIES BUILDING (18,860 gsf)
 - F19 - FUTURE STUD. ACTIVITIES BUILDING (18,860 gsf)
 - F20 - FUTURE OFFICE (4,480 gsf)
 - F21 - FUTURE ACADEMIC BUILDING (105,080 gsf)
 - F22 - FUTURE LAB BUILDING (32,320 gsf)
 - F23 - FUTURE SUPPORT BUILDING (21,450 gsf)
 - F24 - FUTURE OFFICE (4,480 gsf)
 - F25 - FUTURE STUD. ACTIVITIES BUILDING (18,860 gsf)
 - F26 - FUTURE RETAIL OFFICE BUILDING (3,450 gsf)
 - F27 - FUTURE HOUSING BUILDING (137,560 gsf)
- UTILITY DISTRIBUTION:**
- GAS: (Orange line)
 - DOMESTIC WATER: (Blue line)
 - SANITARY SEWER: (Green line)
 - STORM DRAIN: (Purple line)
 - STEAM: (Yellow line)
 - CHILLED WATER: (Light Blue line)
 - CORE CAMPUS: (Dashed line)
 - APPROXIMATE BOUNDARY: (Dashed line)
- SANITARY SEWER ONLY:** (Green hatched area)

14 13 12 11 10 9 8 7 6 5 4 3 2 1

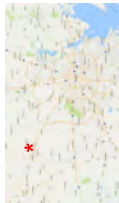

SITE LOCATION
 PRAIRIE VIEW A&M UNIVERSITY
 100 ENERGY WAY SUITE 1900
 FORT WORTH, TEXAS 76102
 PRAIRIE VIEW, TX 77446

BURNS & MCDONNELL
 100 ENERGY WAY SUITE 1900
 FORT WORTH, TEXAS 76102
 817.637.4381



DATE	10/20/2017	DESIGNED	PKY
DESIGNED	PKY	CHECKED	ATF

2017 UTILITY MASTER PLAN
 FTTP GENERAL ARRANGEMENT DRAWING
 CURRENT LAYOUT (2017)

Project: 98470
 Drawing: rev.

SK16 - 0

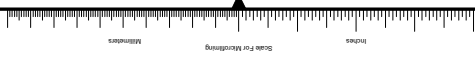
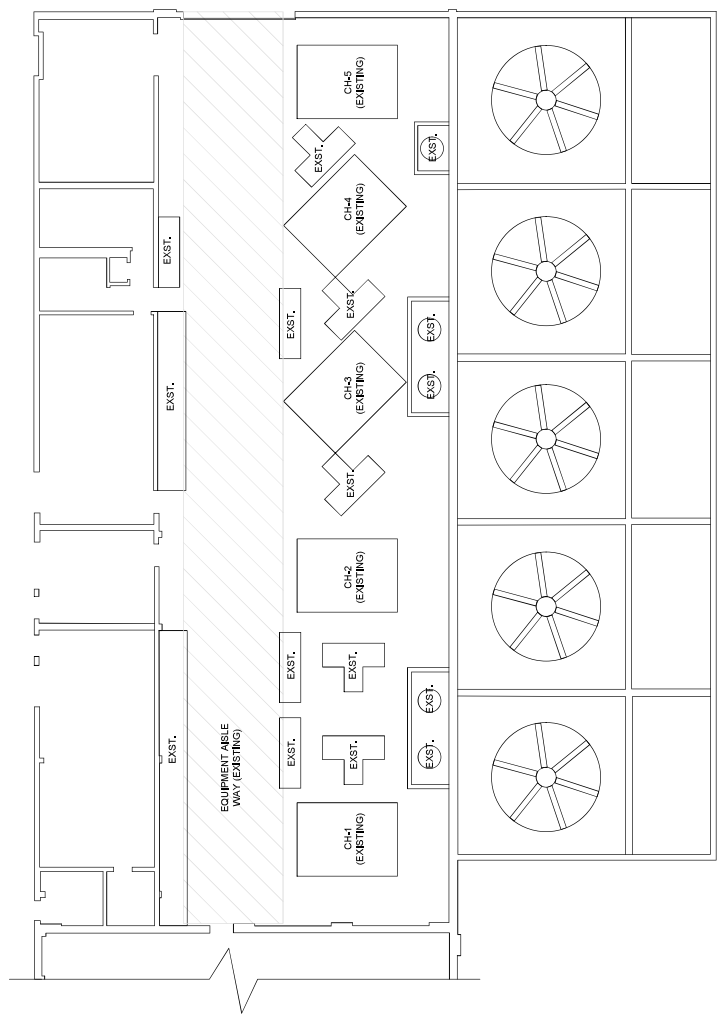

14 13 12 11 10 9 8 7 6 5 4 3 2 1

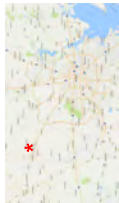

SITE LOCATION
 PRAIRIE VIEW A&M UNIVERSITY
 100 ENERGY WAY, SUITE 1900
 FORT WORTH, TEXAS 76102
 PRAIRIE VIEW, TX 77446

BURNS & MCDONNELL
 100 ENERGY WAY, SUITE 1900
 FORT WORTH, TEXAS 76102
 817.637.4381



DATE	10/20/2017	DESIGNED	PKY
DESIGNED	PKY	CHECKED	ATF

2017 UTILITY MASTER PLAN
 FTTP GENERAL ARRANGEMENT DRAWING
 PICTURE BUILDOUT (2016)

Project: 98470
 Drawing: SK17 - 0

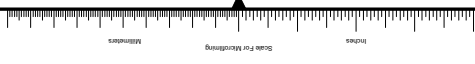
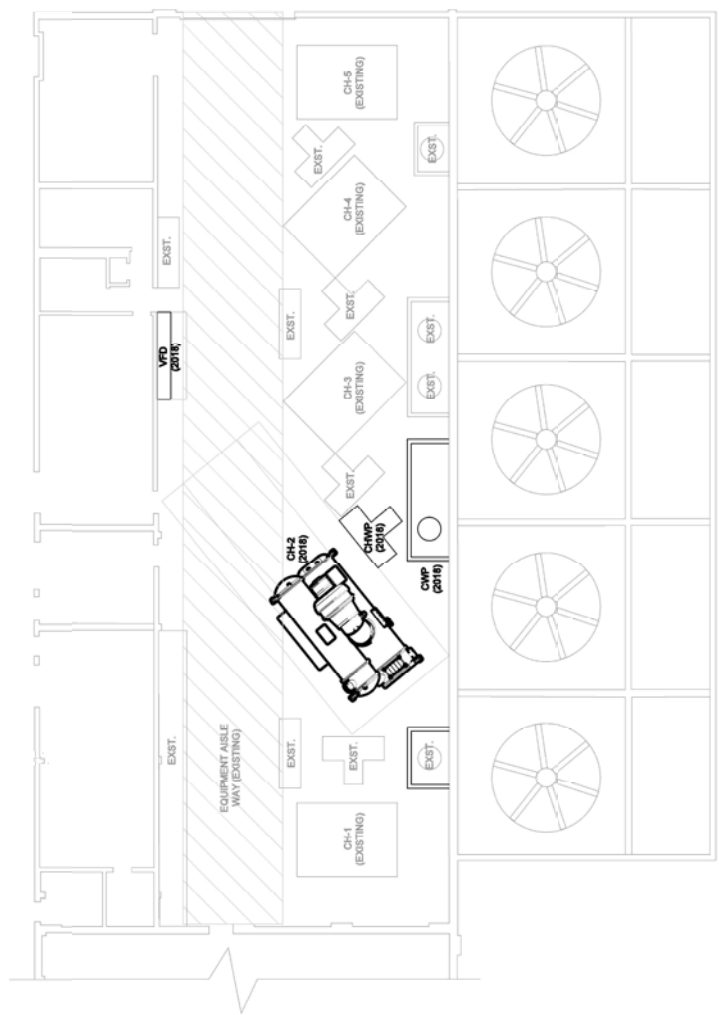

1 2 3 4 5 6 7 8 9 10 11 12 13 14

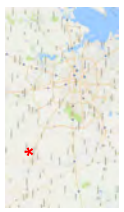

SITE LOCATION
 PRAIRIE VIEW A&M UNIVERSITY
 100 ENERGY WAY SUITE 1900
 PRAIRIE VIEW, TX 77446

BURNS & MCDONNELL
 100 ENERGY WAY SUITE 1900
 PRAIRIE VIEW, TX 77446
 817.437.4391



DATE	10/20/2017	DESIGNED	PKY
DESIGNED BY	PKY	CHECKED	ATF

2017 UTILITY MASTER PLAN
 FTTP GENERAL ARRANGEMENT DRAWING
 PICTURE BUILDOUT (2020)

Project: 98470
 Drawing: SK18 - 0

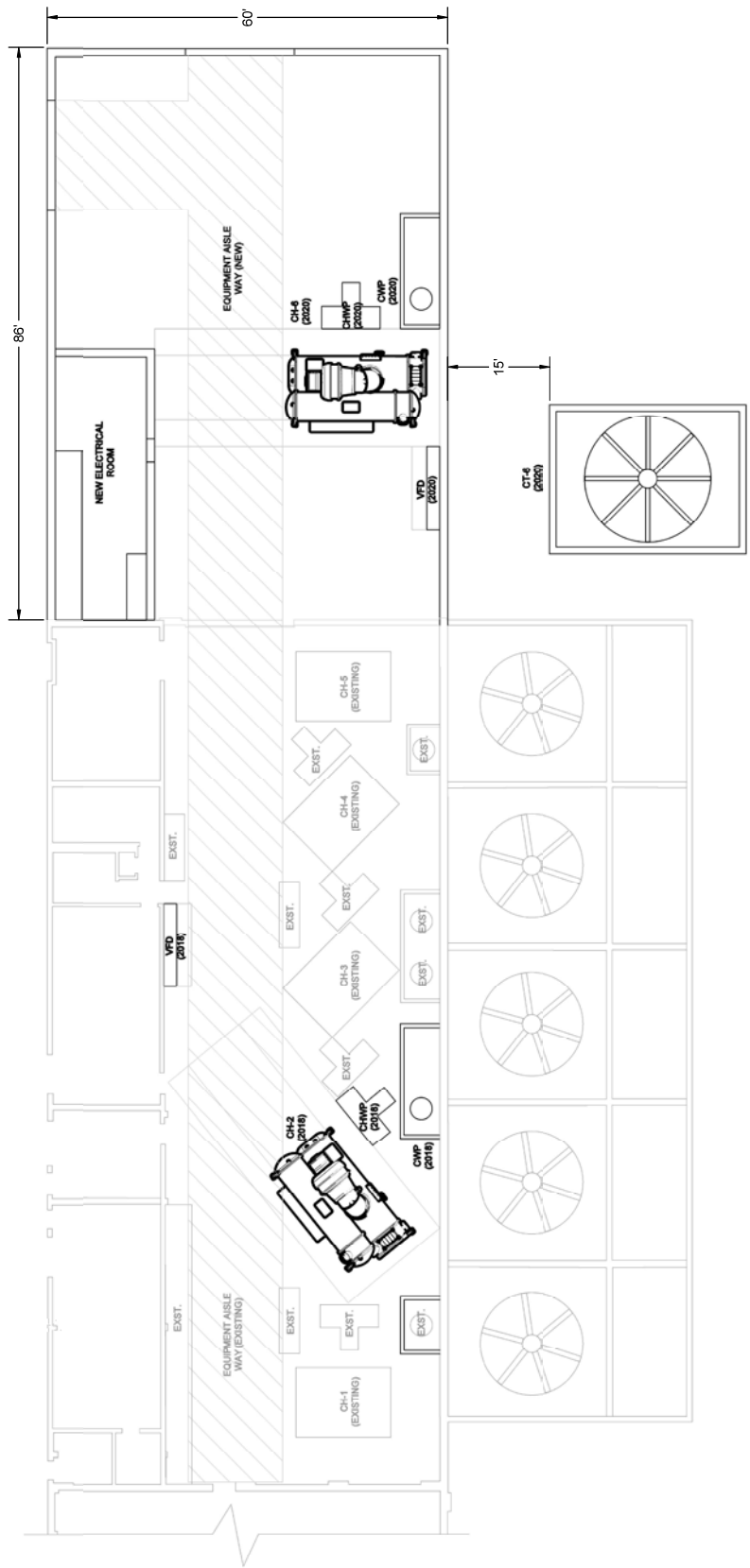

1 2 3 4 5 6 7 8 9 10 11 12 13 14

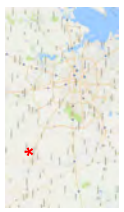

SITE LOCATION
 PRAIRIE VIEW A&M UNIVERSITY
 100 ENERGY WAY SUITE 1900
 FORT WORTH, TEXAS 76102
 PRAIRIE VIEW, TX 77446

BURNS & MCDONNELL
 100 ENERGY WAY SUITE 1900
 FORT WORTH, TEXAS 76102
 817.377.4391



DATE	10/20/2017	DESIGNED	PKY
DESIGNED	PKY	CHECKED	ATF

2017 UTILITY MASTER PLAN
 FTTP GENERAL ARRANGEMENT DRAWING
 PICTURE BUILDOUT (2022)

Project: 98470
 Drawing: SK19 - 0

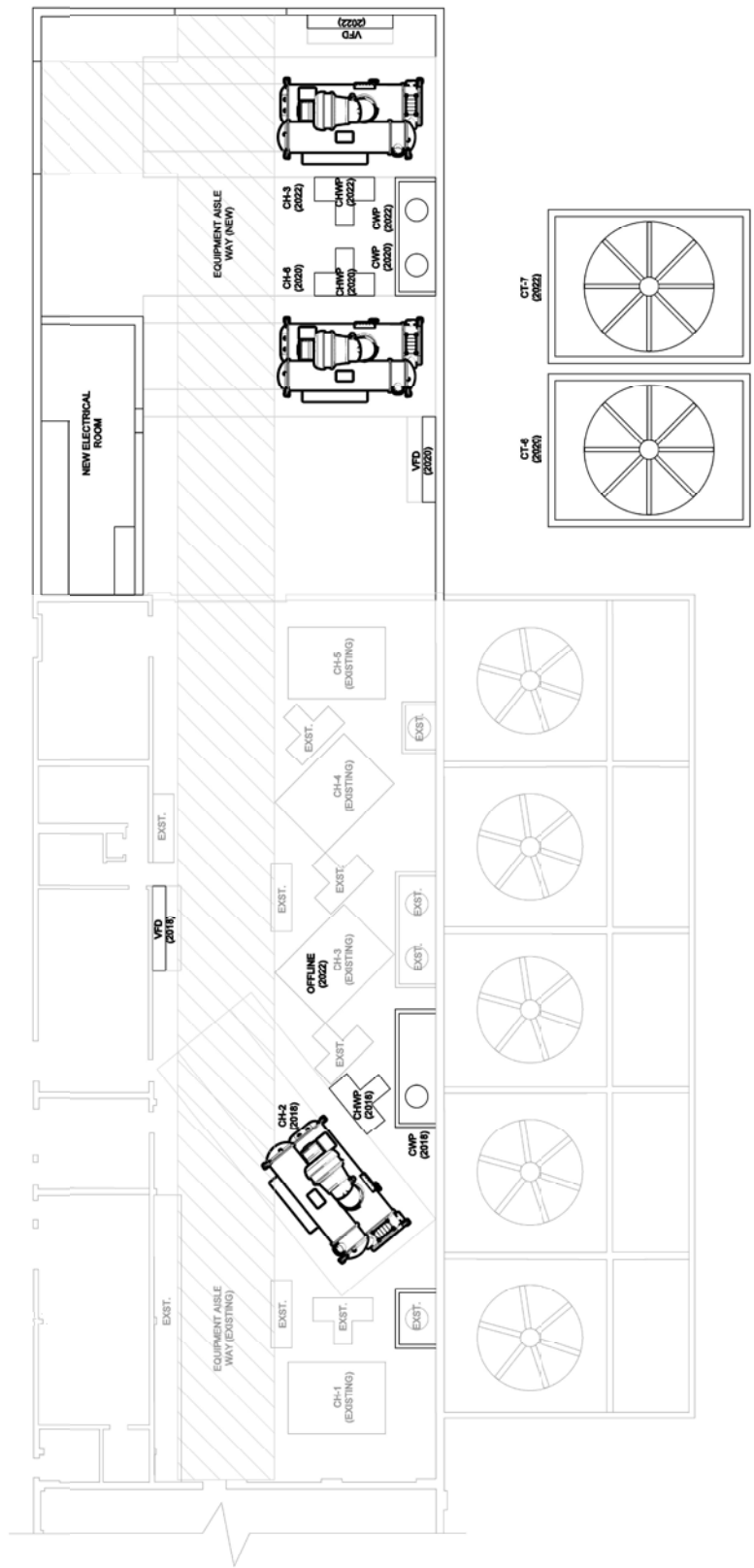

1 2 3 4 5 6 7 8 9 10 11 12 13 14

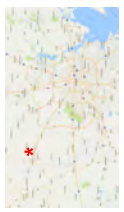

SITE LOCATION
 PRAIRIE VIEW A&M UNIVERSITY
 100 ENERGY WAY SUITE 1900
 FORT WORTH, TEXAS 76102
 PRAIRIE VIEW, TX 77446

BURNS & MCDONNELL
 100 ENERGY WAY SUITE 1900
 FORT WORTH, TEXAS 76102
 817.377.4391



DATE	10/20/2017	DESIGNED	PKY
DESIGNED	PKY	CHECKED	ATF

2017 UTILITY MASTER PLAN
 FTTP GENERAL ARRANGEMENT DRAWING
 PICTURE BUILDOUT (2025)

Project: 98470
 Drawing: SK20 - 0

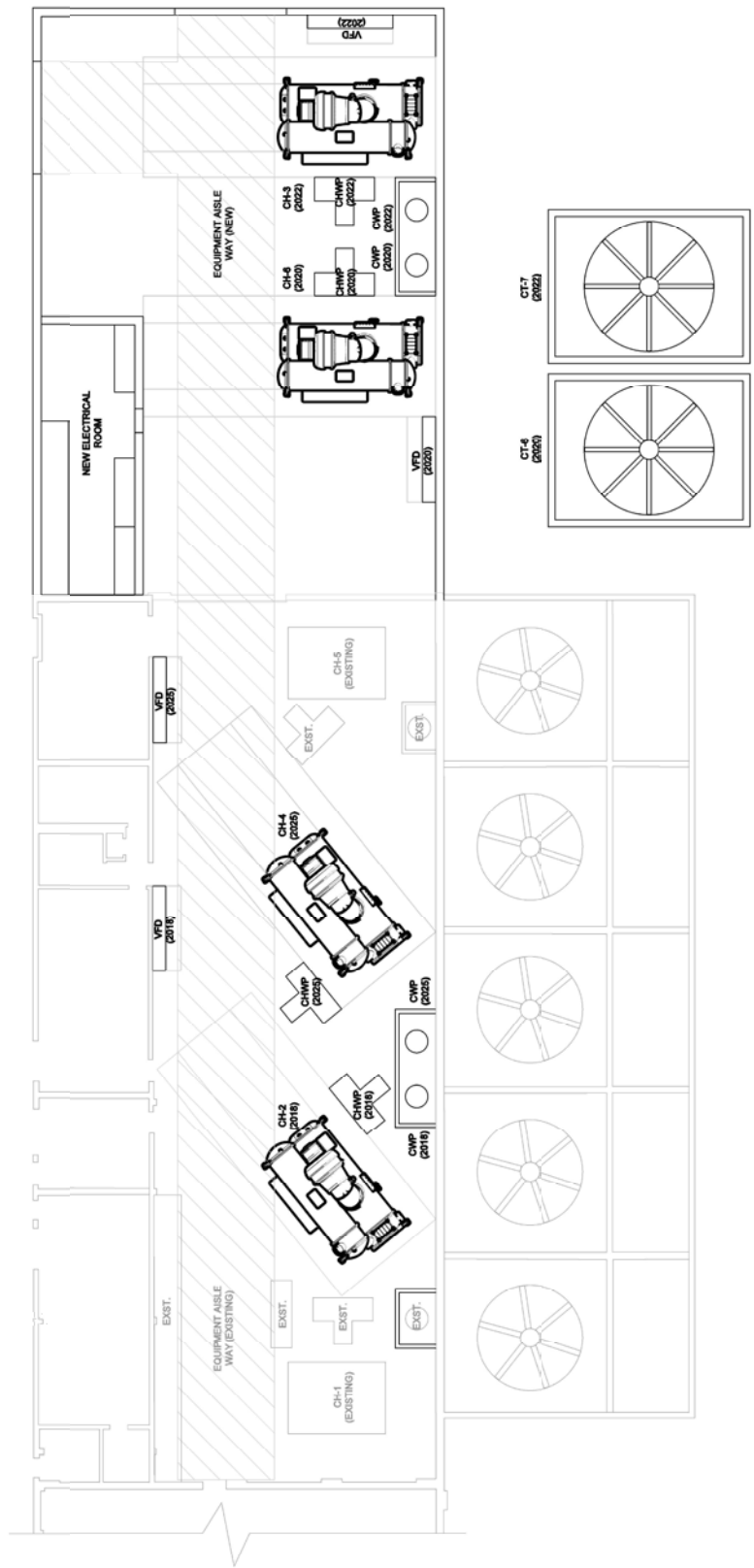

1 2 3 4 5 6 7 8 9 10 11 12 13 14

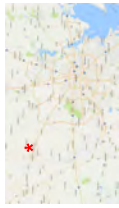

SITE LOCATION
 PRAIRIE VIEW A&M UNIVERSITY
 100 ENERGY WAY SUITE 1900
 FORT WORTH, TEXAS 76102
 PRAIRIE VIEW, TX 77446

BURNS & MCDONNELL
 100 ENERGY WAY SUITE 1900
 FORT WORTH, TEXAS 76102
 817.437.4381



DATE	10/20/2017	DESIGNED	PKY
DESIGNED		DRAWN	ATF

2017 UTILITY MASTER PLAN
 FTTP GENERAL ARRANGEMENT DRAWING
 PULL FUTURE BUILDOUT (2025)

Project: 58470
 Drawing: SK21 - 0

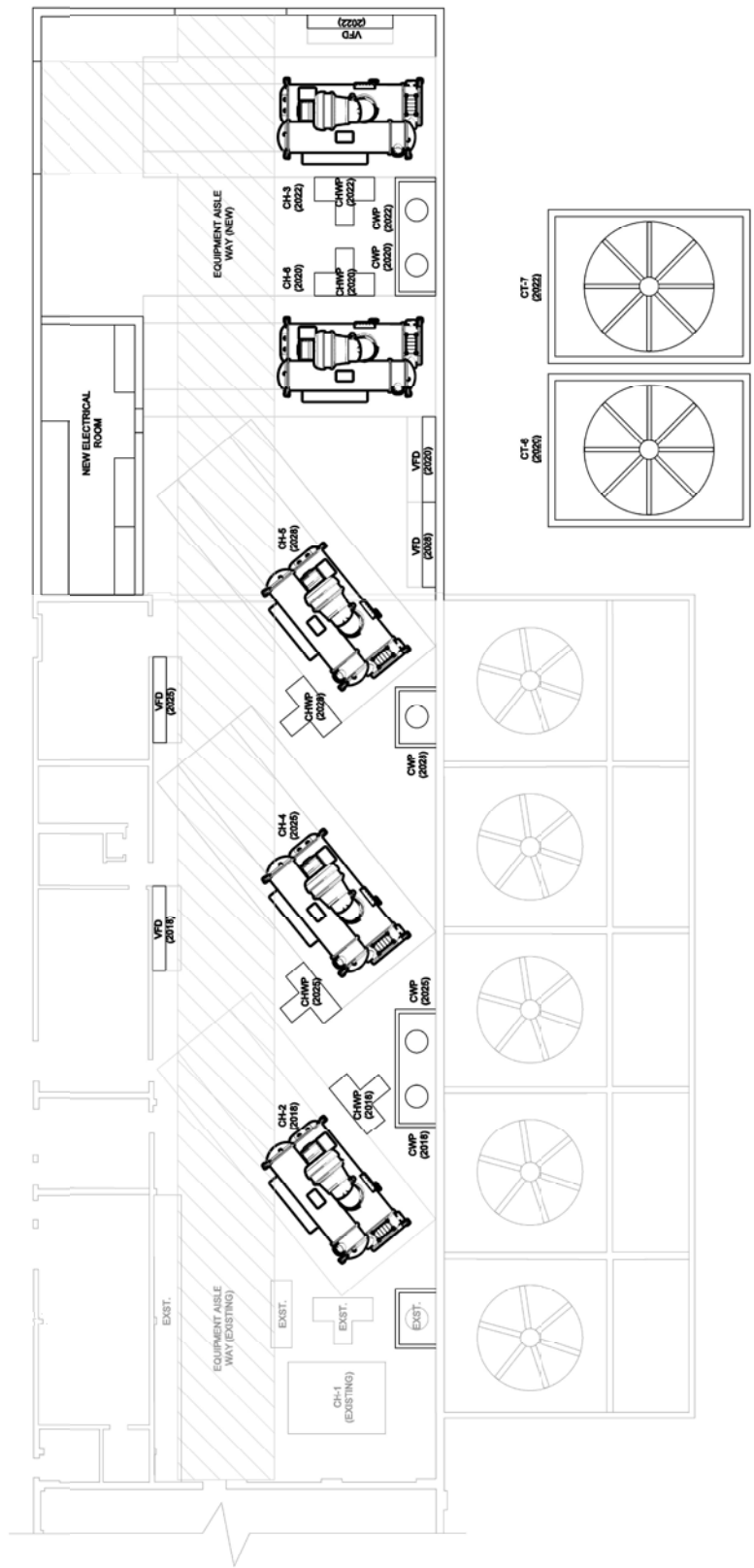

14 13 12 11 10 9 8 7 6 5 4 3 2 1

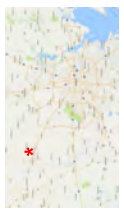

SITE LOCATION
 PRAIRIE VIEW A&M UNIVERSITY
 100 ENERGY WAY SUITE 1900
 FORT WORTH, TEXAS 76102
 PRAIRIE VIEW, TX 77446

BURNS & MCDONNELL
 100 ENERGY WAY SUITE 1900
 FORT WORTH, TEXAS 76102
 817.437.4361



DATE	10/20/2017	DESIGNED	PKY
DESIGNED BY	PKY	CHECKED	ATF

2017 UTILITY MASTER PLAN
 FTTP GENERAL ARRANGEMENT DRAWING
 PULL FUTURE BULDOZER (2025)
 PROJECT 58470
 DRAWING 58470

SK22 - 0

